

SR2169 - KR2169

PORTAPACCO SPECIFICO - SPECIFIC HOLDER - PORTE-PAQUET SPÉCIFIQUE - SPEZIFISCHER TRÄGER - PORTA-EQUIPAJE ESPECÍFICO - TRANSPORTADOR ESPECÍFICO

N°	Descrizione/Description	Caratteristiche/Features	Codice/Code	Quantità/Quantity
1	Supporto laterale - Lateral support - Untere Halterung Support latéral - Soporte lateral - Suporte lateral	-	2169SRDXV 2169SRSXV	2(Right; Left)
2	Supporto anteriore - Front support - Support avant Vordere Unterstützung - Soporte frontal - Suporte frontal	-	GL6015DXV GL6015SXV	2(Right; Left)
3	Supporto posteriore - Rear support - Hintere Unterstützung Support arrière - Soporte trasero - Suporte traseiro	-	GL6013DXV GL6013SXV	2(Right; Left)
4	Supporto superiore - Support higher - Support supérieur Halterung höher - Soporte superior - Apoio superior	-	GL6016DXV GL6016SXV	2(Right; Left)
5	Supporto Aggiuntivo - Additional Support - Supplémentaires Support Ausätzlich Halterung - Adicional Soporte - Suporte Adicional	-	GL6014P	1
6	Vite - Screw - Vis - Schraube Tornillo - Parafuso	M8x25 TE	825TE	4
7	Vite - Screw - Vis - Schraube Tornillo - Parafuso	M8x20 TBEI	820TBEI	4
8	Vite - Screw - Vis - Schraube Tornillo - Parafuso	M8x30 TBEIFH	830TBEIFH	10
9	Rondella - Washer - Rondelle - Scheibe Arandela - Arruela	Foro Ø8mm	8RON	4
10	Rondella - Washer - Rondelle - Scheibe Arandela - Arruela	Foro Ø8mm / Esterno Ø14mm / Sp.0,3mm	805RONX	4
11	Distanziale - Spacer - Entretoise Distanzstueck - Distanciadador - Espaçador	Ø12x12 Foro 8,5mm	C12L12F8,5T	10
12	Dado - Bolt - Ecrow Mutter - Tuerca - Porca	Dado Autobloccante Flangiato M8 (H9,5mm)	8DADIFN	14
13	Tappo - Cap - Fiche - Stecker Enchufe - Capa	-	13COP	10
14	MOUSSE	L.160MM	Z2306	1
15	Componenti Originali - Original Parts Parties Originales - Original Bauteile Componentes Originales - Componentes Originais	-	-	-
16	Particolari Inclusi Nel Kit Viteria Della Piastra Components Included In The Fitting Kit Of The Plate Pièces Inclues Dans Le Kit De Vis De La Platine Die Einzelnen Teile Sind Bei Montagekit Der Platte Enthalten Despieces Incluidos En El Kit De Anclajes De La Parrilla Explodiu Incluído No Kit As Âncoras Da Grelha	-	-	-

IT_ Nel caso in cui sulle viti originali sia presente del frenafilletti, ripristinarlo durante il montaggio dell'accessorio.

EN_ If there is threadlocker on the original screws, use threadlocker when mounting the accessory.

DE_ Falls sich auf den Originalschrauben Schraubensicherungsstoff befand, sollte dieser auch bei der Montage des Zubehörs wieder aufgetragen werden

FR_ Si du frein filet est présent sur les vis d'origine, l'appliquer également lors du montage de l'accessoire

ES_ En caso de que el fijador de roscas se encuentre presente en los tornillos originales, colocarlo nuevamente en el montaje del accesorio

PT_ Se houver trava rosca nos parafusos originais, inserir novamente durante a montagem do acessório

SR2169 - KR2169

PORTAPACCO SPECIFICO - SPECIFIC HOLDER - PORTE-PAQUET SPÉCIFIQUE - SPEZIFISCHER TRÄGER - PORTA-EQUIPAJE ESPECÍFICO - TRANSPORTADOR ESPECÍFICO

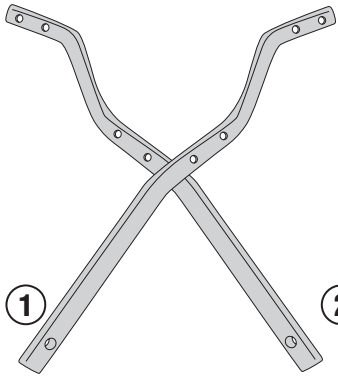

2169SRDXV/2169SRSXV

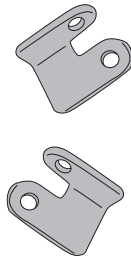

2

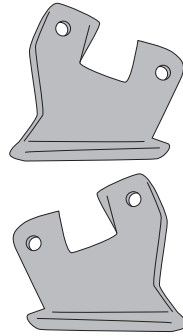

3

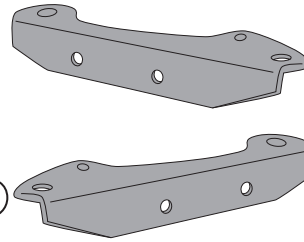

4

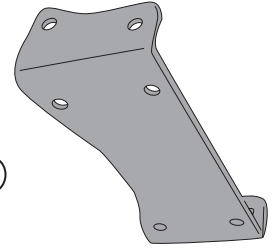

5

GL6015DXV/GL6015SXV GL6013DXV/GL6013SXV

GL6016DXV/GL6016SXV

GL6014P

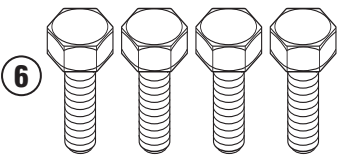

M8x25mm

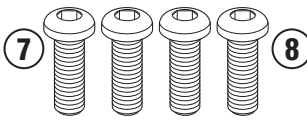

M8x20mm

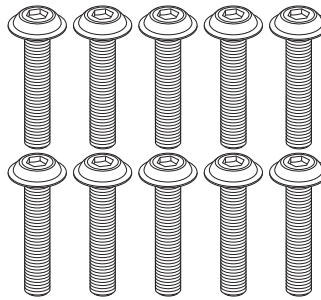

M8x30mm



Hole Ø8mm



Hole Ø8mm/
External Ø14mm/
Th.0.3mm

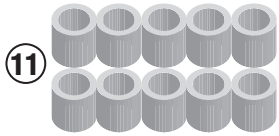

Hole Ø8,5mm/
External Ø12mm/
H.12mm

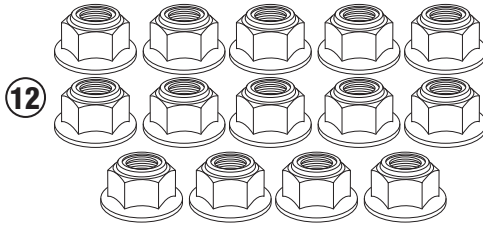

M8

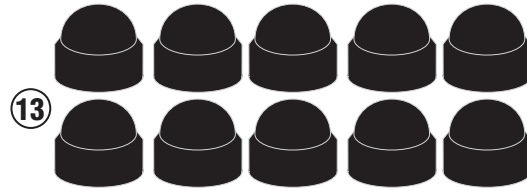

13COP



Z2306

10mm / 13mm

4mm / 5mm

12mm

CHECK THE SCREW LENGTH HERE

SR2169 - KR2169

PORTAPACCO SPECIFICO - SPECIFIC HOLDER - PORTE-PAQUET SPÉCIFIQUE - SPEZIFISCHER TRÄGER - PORTA-EQUIPAJE ESPECÍFICO - TRANSPORTADOR ESPECÍFICO

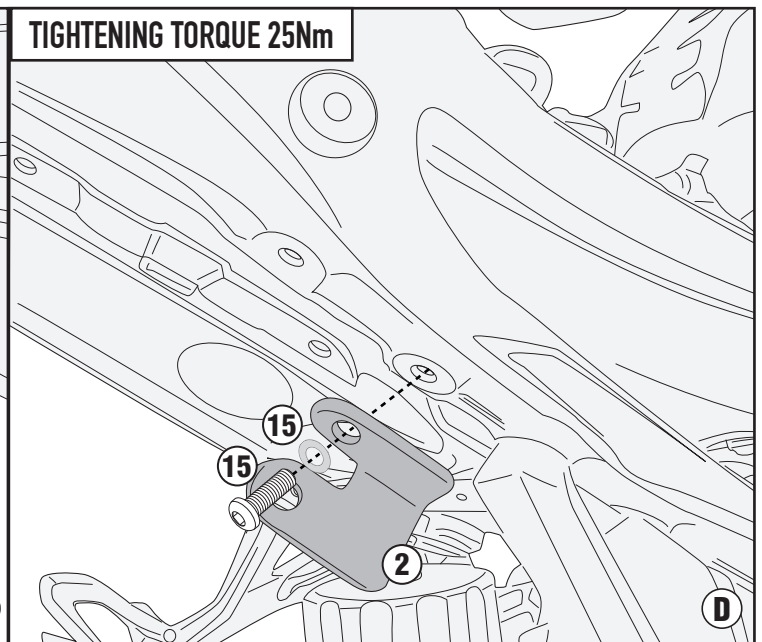
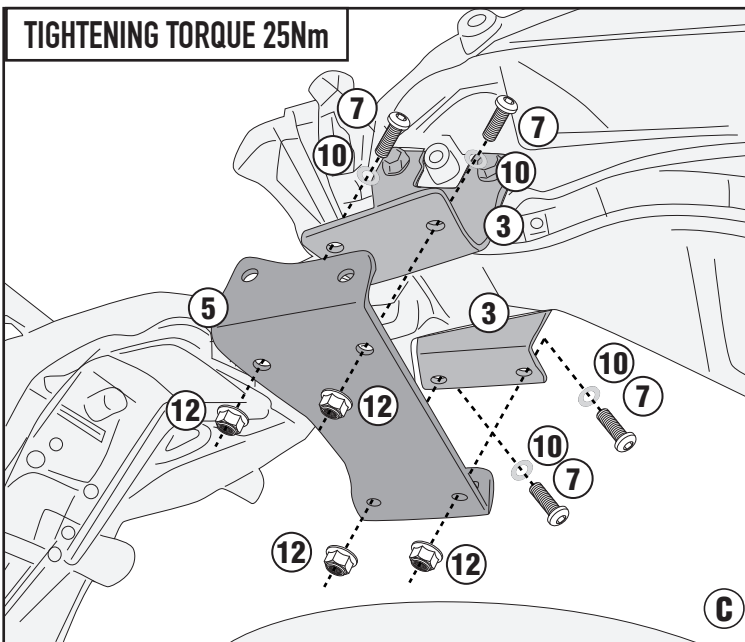
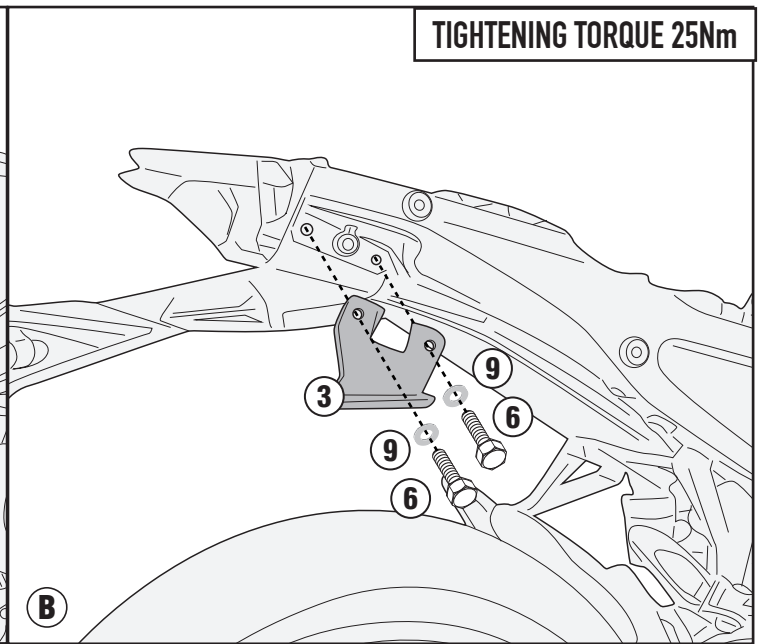
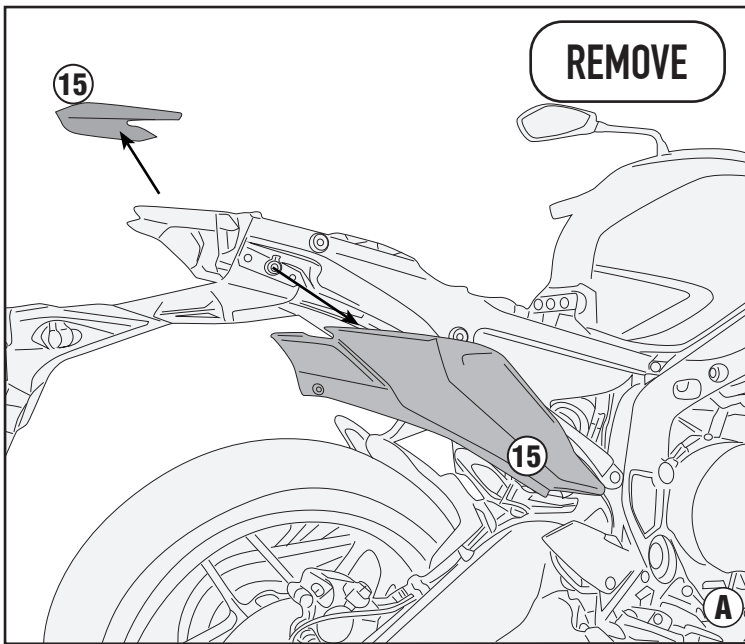
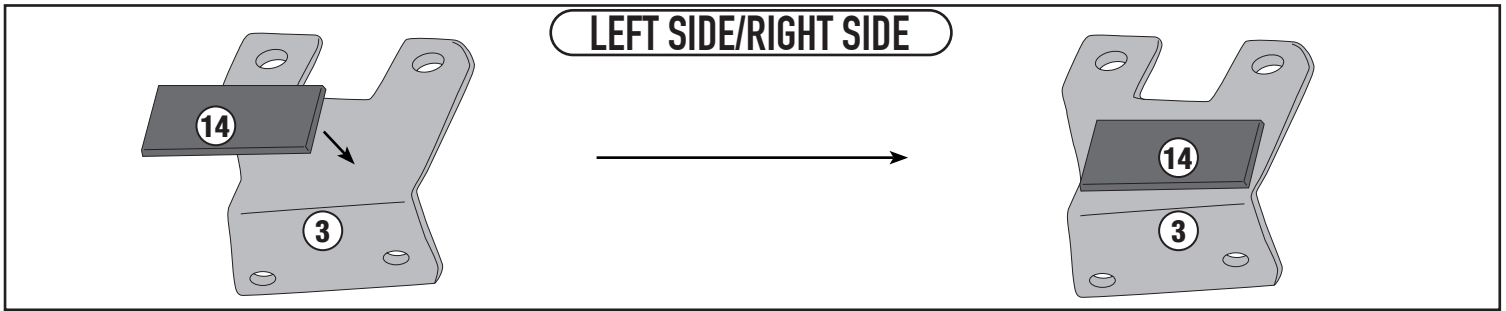
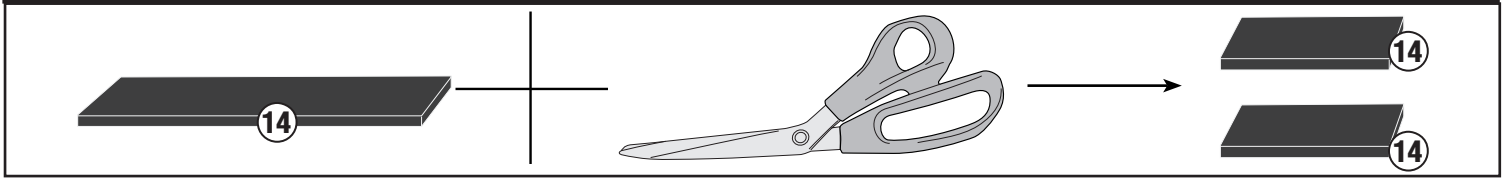

SR2169 - KR2169

PORTAPACCO SPECIFICO - SPECIFIC HOLDER - PORTE-PAQUET SPÉCIFIQUE - SPEZIFISCHER TRÄGER - PORTA-EQUIPAJE ESPECÍFICO - TRANSPORTADOR ESPECÍFICO

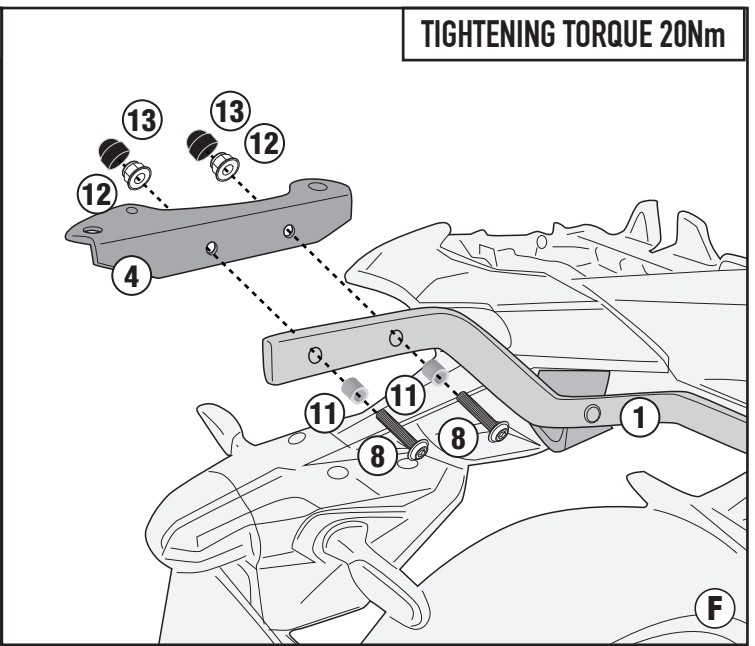
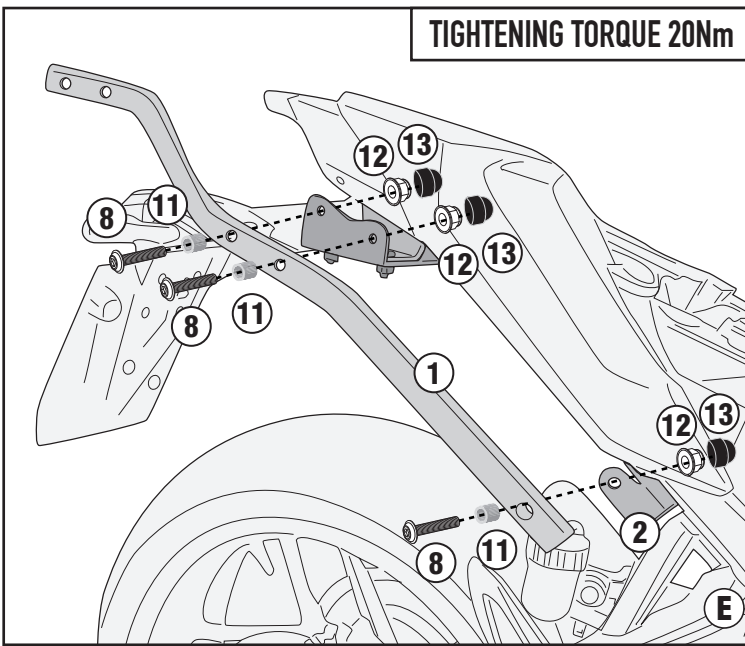

ITA - Attenzione: Serrando le viti N°8 il supporto tubolare N°1 si dovrà deformare leggermente.
 ENG - Attention: By tightening screws N°8 the tubular support N°1 will have to deform slightly.
 DEU - Achtung: Beim Anziehen der Schrauben Nr8 sollte sich die Rohrhalterung Nr. 1 leicht verformen.
 FRA - Attention: En serrant les vis N°8 le support tubulaire N°1 devra se déformer légèrement.
 SPA - Atención: Apretando los tornillos N°8 el soporte tubular N°1 deberá deformarse ligeramente.
 POR - Atenção: Ao apertar os parafusos N°8 o suporte tubular N°1 terá de se deformar ligeiramente.

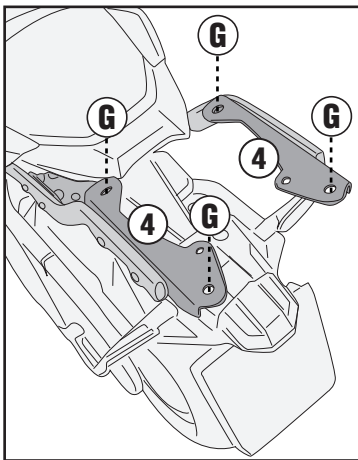

M5/M5M/M6M PLATE

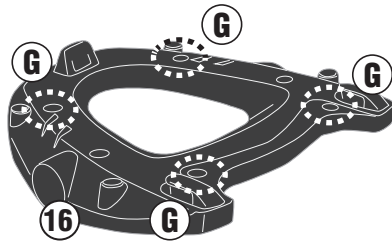

TIGHTENING TORQUE 7,5Nm

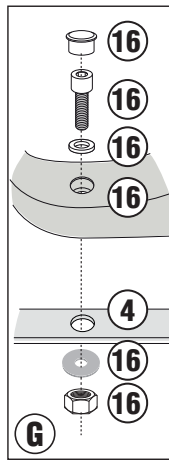

M8 PLATE

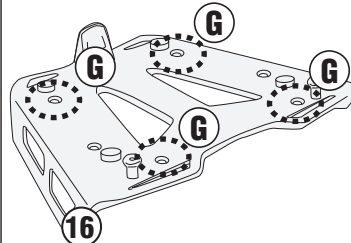

TIGHTENING TORQUE 9,5Nm

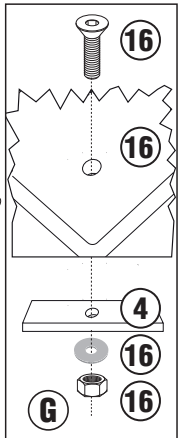

M9 PLATE

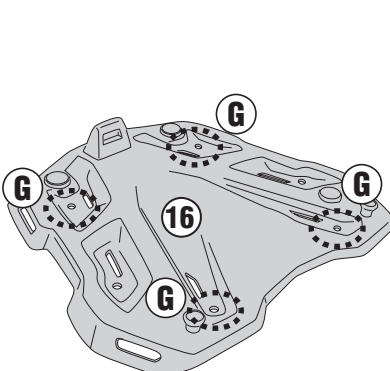

TIGHTENING TORQUE 9,5Nm

UNIVERSAL MONOLOCK PLATE (SPARE PART Z113C2)

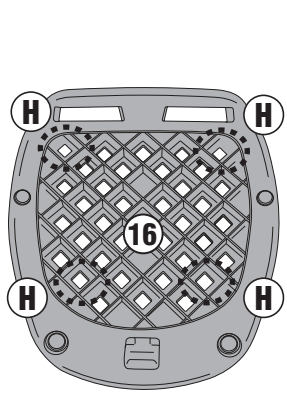
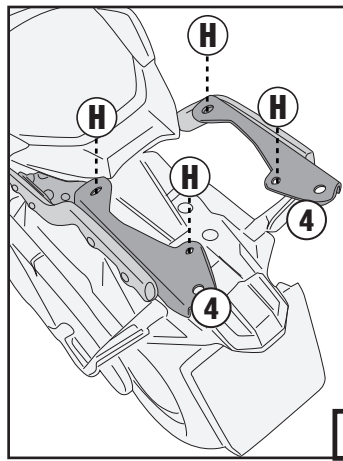

TIGHTENING TORQUE 7,5Nm

