

# PX3128

PORTAVALIGIE LATERALE SPECIFICO - SPECIFIC TUBULAR SIDE-CASE HOLDER - PORTE-VALISES LATÉRAUX SPÉCIFIQUE  
SPEZIFISCHES STAHLROHR-SEITENTRAEGER - PORTA MALETAS LATERALES ESPECÍFICO - SUPORTE DE MALAS ESPECÍFICO

N°	Descrizione/Description	Caratteristiche/Features	Codice/Code	Quantità/quantity
1	Telaio laterale - Side frame - Châssis latéral Soporte lateral - Seitenrahmen - Suporte lateral	-	GNB3285DXV GNB3285SXV	2 (Right: Left)
2	Supporto inferiore - Lower support - Support inférieur Soporte inferior - Untere Halterung - Suporte inferior	-	GL5886DXV GL5886SXV	2 (Right: Left)
3	Supporto superiore - Support higher - Support supérieur Halterung höher - Soporte superior - Apoio superior	-	GL5884V	2
4	Supporto - Support - Support - Halterung Soporte - Apoio	FOR V37 SIDE CASES (Z8603KIT)	Z8603SX Z8603DX	2 (Right: Left)
5	Protezioni In Gomma - Protective Rubber Pads Protections En Caoutchouc - Schutzgummis Goma Protectora - Borracha de proteção	-	Z9666SX Z9666DX	2 (Right: Left)
6	Vite - Screw - Vis - Schraube Tornillo - Parafuso	TBEIFL M6x20 (Z8603KIT)	620TBEIFL	6
7	Vite - Screw - Vis - Schraube Tornillo - Parafuso	TECF M8x30	830TECF	4
8	Vite - Screw - Vis - Schraube Tornillo - Parafuso	TECF 6x45	645TECF	8
9	Rondella spaccata - Split washer - Scheibe - Rondelle fendue Arandela seccionada - Arruela Dentada	Foro Ø8mm	Z1060	4
10	Rondella - Washer- Rondelle - Scheibe Arandela - Arruela	Foro Ø8mm	8RON	4
11	Rondella spaccata - Split washer - Scheibe - Rondelle fendue Arandela seccionada - Arruela Dentada	Foro Ø6mm	Z1063	8
12	Rondella - Washer- Rondelle - Scheibe Arandela - Arruela	Foro Ø6mm / Esterno Ø18mm / Sp.2mm	618RON	8
13	Distanziale - Spacer - Entretoise - Distanzstueck Distanciador - Espaçador	Ø18x10 Foro 8,5mm	C18L10F8.5T	4
14	Distanziale - Spacer - Entretoise - Distanzstueck Distanciador - Espaçador	Ø10x4 Foro 6mm	C10L4F6T	8
15	Distanziale - Spacer - Entretoise - Distanzstueck Distanciador - Espaçador	Ø14x20 Foro 6,5 mm	C14L20F6.5T	8
16	Dado - Bolt - Ecrou Mutter - Tuerca - Porca	Dado Autobloccante M6 ( H.5,9mm) (Z8603KIT)	6DADIB	6
17	Componenti Originali - Original Parts Parties Originales - Original Bauteile Componentes Originales - Componentes Originais	-	-	-
18	Particolari Inclusi nelle V37 Components Included In The V37 Pièces Inclues Dans V37 Die Einzelnen Teile Sind Bei V37 Despieces Incluidos V37 Componentes inclusos na V37	-	-	-

IT\_ Nel caso in cui sulle viti originali sia presente del frenafilletti, ripristinarlo durante il montaggio dell'accessorio.

EN\_ If there is threadlocker on the original screws, use threadlocker when mounting the accessory.

DE\_ Falls sich auf den Originalschrauben Schraubensicherungsstoff befand, sollte dieser auch bei der Montage des Zubehörs wieder aufgetragen werden

FR\_ Si du frein filet est présent sur les vis d'origine, l'appliquer également lors du montage de l'accessoire

ES\_ En caso de que el fijador de roscas se encuentre presente en los tornillos originales, colocarlo nuevamente en el montaje del accesorio

PT\_ Se houver trava rosca nos parafusos originais, inserir novamente durante a montagem do acessório

# PX3128

PORTAVALIGIE LATERALE SPECIFICO - SPECIFIC TUBULAR SIDE-CASE HOLDER - PORTE-VALISES LATÉRAUX SPÉCIFIQUE  
 SPEZIFISCHES STAHLROHR-SEITENTRAEGER - PORTA MALETAS LATERALES ESPECÍFICO - SUPORTE DE MALAS ESPECÍFICO

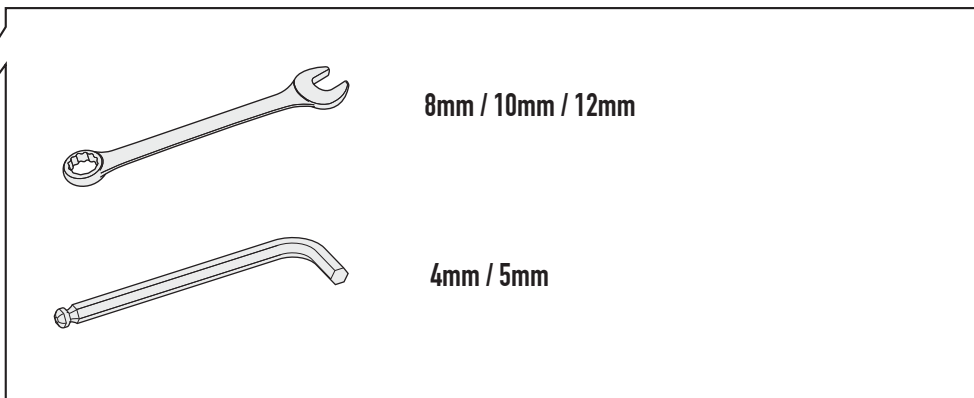
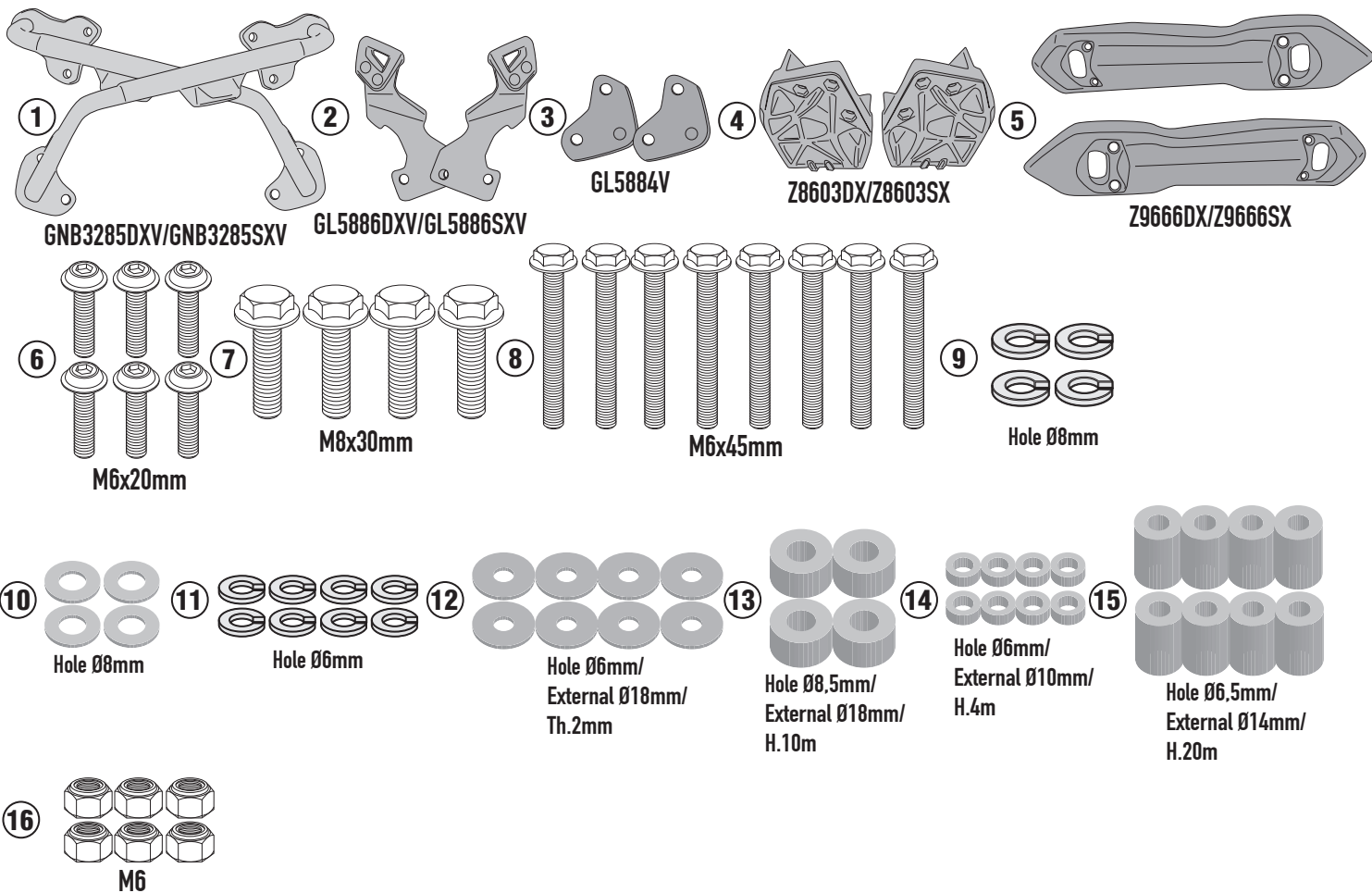

CHECK THE SCREW LENGTH HERE

ISTRUZIONI DI MONTAGGIO - MOUNTING INSTRUCTIONS  
 INSTRUCTIONS DE MONTAGE - BAUANLEITUNG  
 INSTRUCCIONES DE MONTAJE - INSTRUÇÕES DE MONTAGEM



# PX3128

PORTAVALIGIE LATERALE SPECIFICO - SPECIFIC TUBULAR SIDE-CASE HOLDER - PORTE-VALISES LATÉRAUX SPÉCIFIQUE  
SPEZIFISCHES STAHLROHR-SEITENTRAEGER - PORTA MALETAS LATERALES ESPECÍFICO - SUPORTE DE MALAS ESPECÍFICO

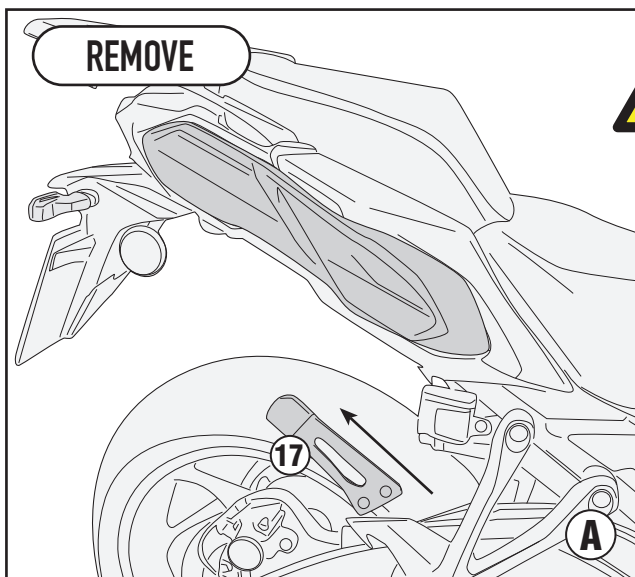

- SOLO PER MOTO CON ATTACCO VALIGIE LATERALI OPTIONAL
- ONLY FOR MOTORBIKES WITH OPTIONAL SIDE CASE SUPPORT
- UNIQUEMENT POUR LES MOTOS AVEC SUPPORT DE BALISE LATÉRALE EN OPTION
- NUR FÜR MOTORRÄDER MIT OPTIONALER SEITENKOFFERHALTERUNG
- SÓLO PARA MOTOCICLETAS CON SOPORTE DE MALETA LATERAL OPCIONAL
- SOMENTE PARA MOTOS COM SUPORTE DE CASA LATERAL OPCIONAL

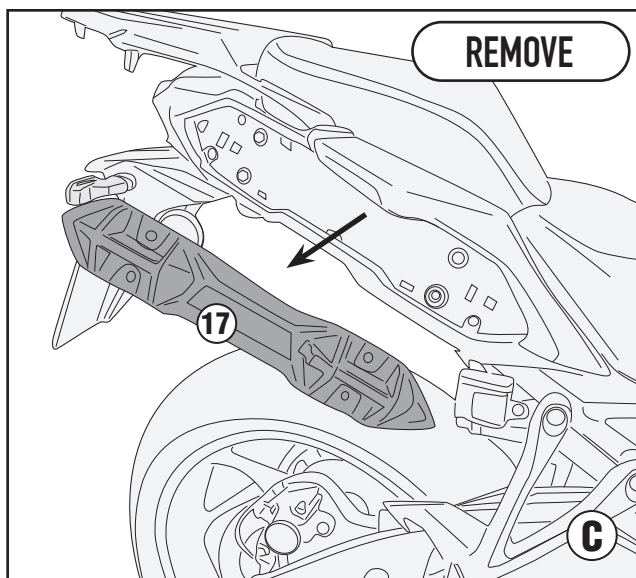
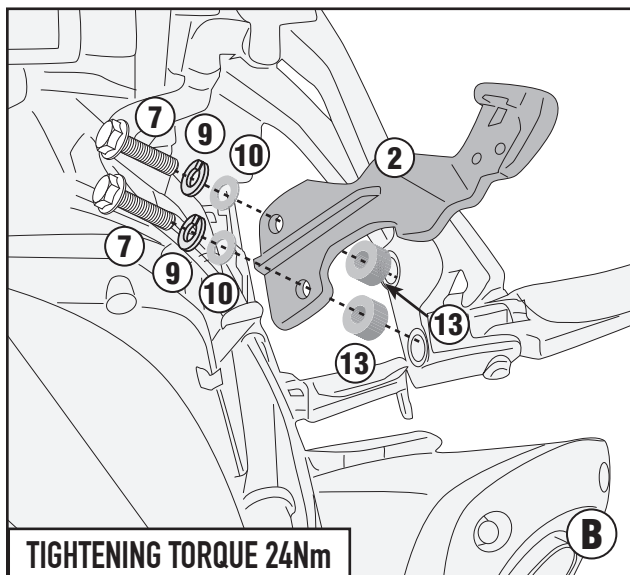

OR

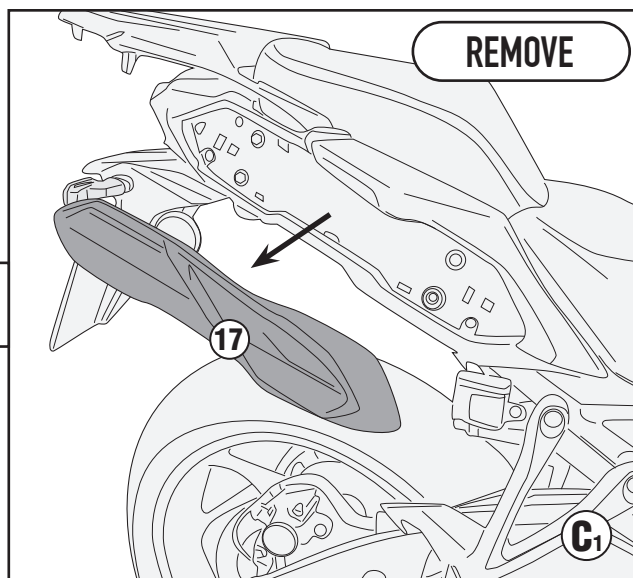

# PX3128

PORTAVALIGIE LATERALE SPECIFICO - SPECIFIC TUBULAR SIDE-CASE HOLDER - PORTE-VALISES LATÉRAUX SPÉCIFIQUE  
 SPEZIFISCHES STAHLROHR-SEITENTRAEGER - PORTA MALETAS LATERALES ESPECÍFICO - SUPORTE DE MALAS ESPECÍFICO

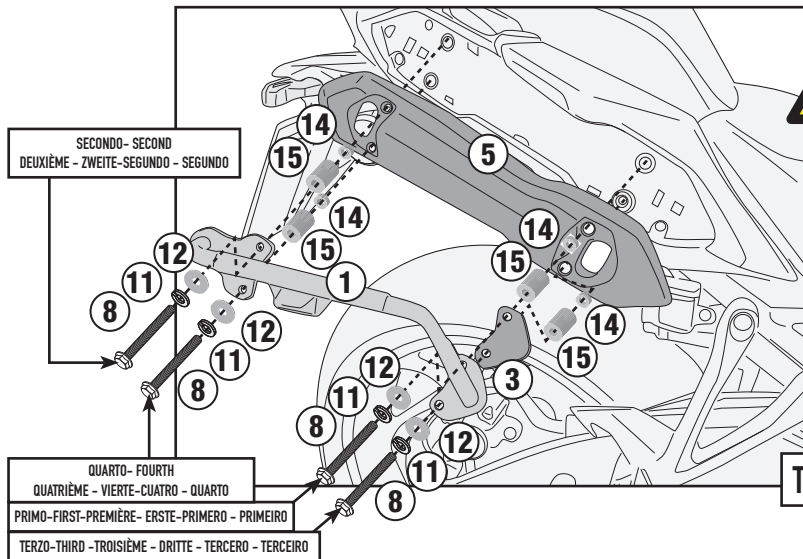

- AVVITARE SEGUENDO L'ORDINE INDICATO
- SCREW IN THE ORDER INDICATED
- SCHRAUBEN SIE DIE SCHRAUBEN IN DER ANGEGEBENEN REIHENFOLGE EIN
- VISSER DANS L'ORDRE INDIQUÉ
- ATORNILLAR EN EL ORDEN INDICADO
- APARAFUSE NA ORDEM INDICADA

TIGHTENING TORQUE 10Nm

## V37 SIDE CASES MOUNTING

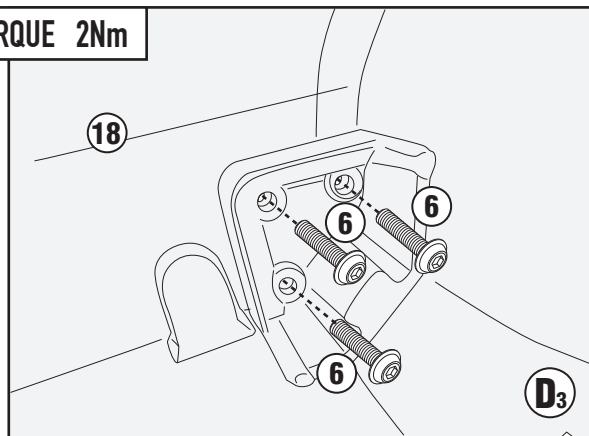
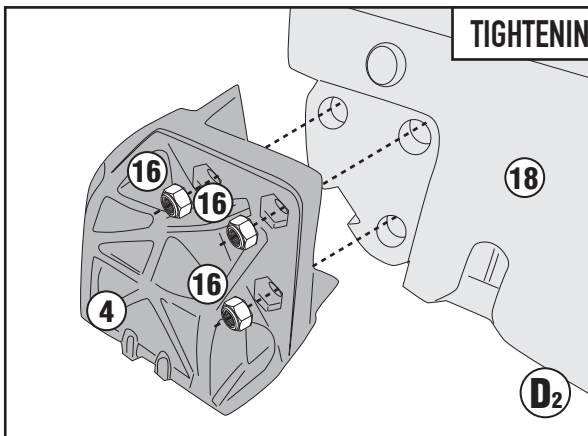
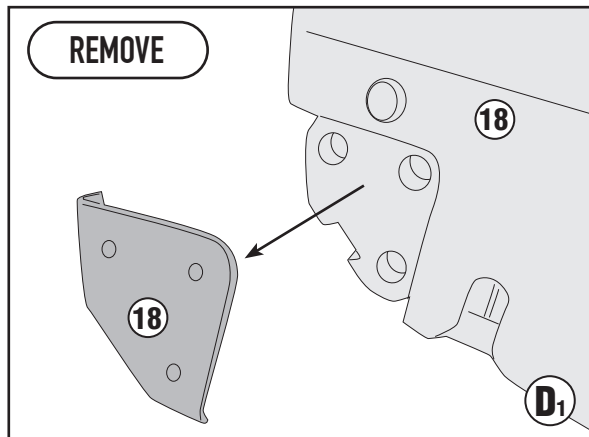
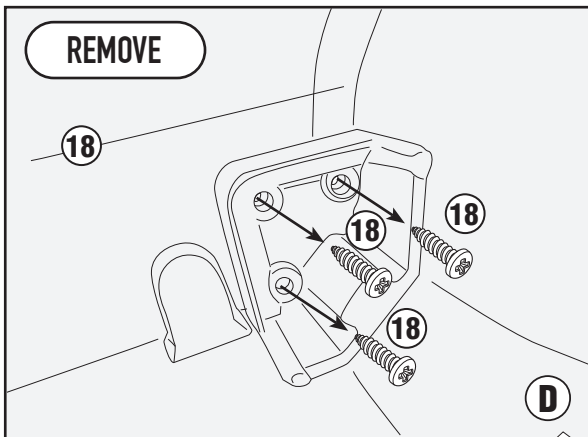
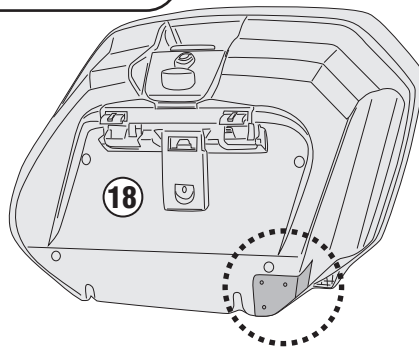
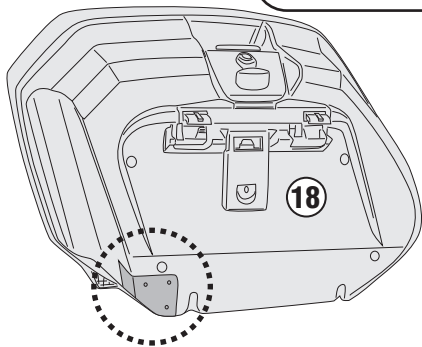

ISTRUZIONI DI MONTAGGIO - MOUNTING INSTRUCTIONS  
 INSTRUCTIONS DE MONTAGE - BAUANLEITUNG  
 INSTRUCCIONES DE MONTAJE - INSTRUÇÕES DE MONTAGEM



# PX3128

PORTAVALIGIE LATERALE SPECIFICO - SPECIFIC TUBULAR SIDE-CASE HOLDER - PORTE-VALISES LATÉRAUX SPÉCIFIQUE  
SPEZIFISCHES STAHLROHR-SEITENTRAEGER - PORTA MALETAS LATERALES ESPECÍFICO - SUPORTE DE MALAS ESPECÍFICO



- Verificare il corretto aggancio della valigia assicurandosi che ENTRAMBI i perni segnalatori siano scattati
- Always ensure the correct hooking of the bag: making sure BOTH signaling pins are engaged
- Überprüfen sie, ob der koffer richtig befestigt ist und ob BEIDE signalisierstifte eingerastet sind.
- Vérifier le bon engagement de la valise, que les DEUX broches de signalisation sont bien enclenchés
- Verificar el correcto enganche de la maleta asegurándose que AMBOS pins de señalización se han activado
- Verificar a correta fixação do baú ao suporte, garantindo que AMBOS os pinos de sinalização estão acionados

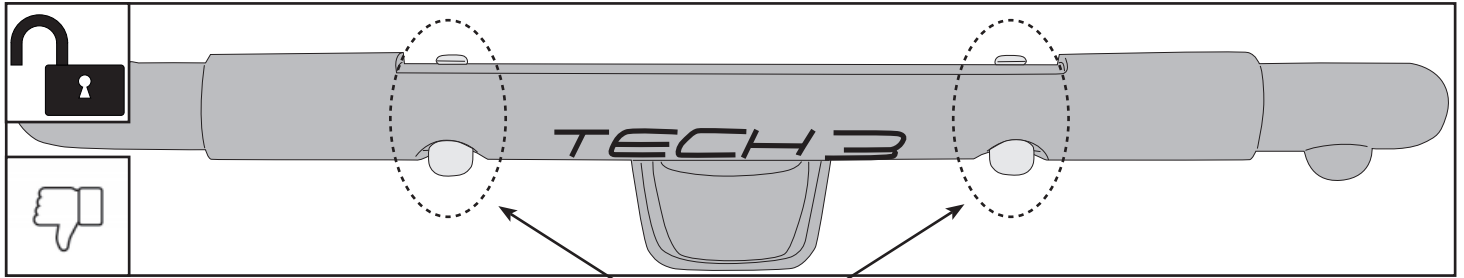

- PERNI SEGNALATORI  
- SIGNALING PINS  
- SIGNALISIERSTIFTE

- BROCHES DE SIGNALISATION  
- PINS DE SEÑALIZACIÓN  
- PINOS DE SINALIZAÇÃO

VERDE - GREEN  
VERT - GRÜN  
VERDE - VERDE

VERDE - GREEN  
VERT - GRÜN  
VERDE - VERDE

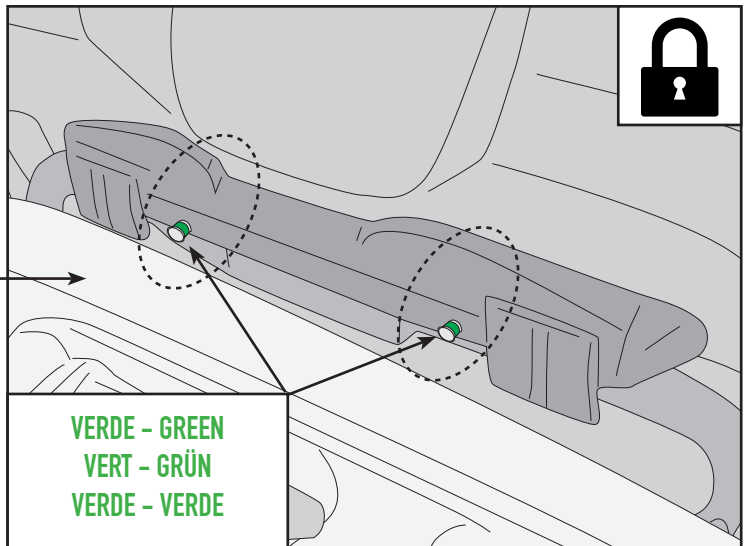
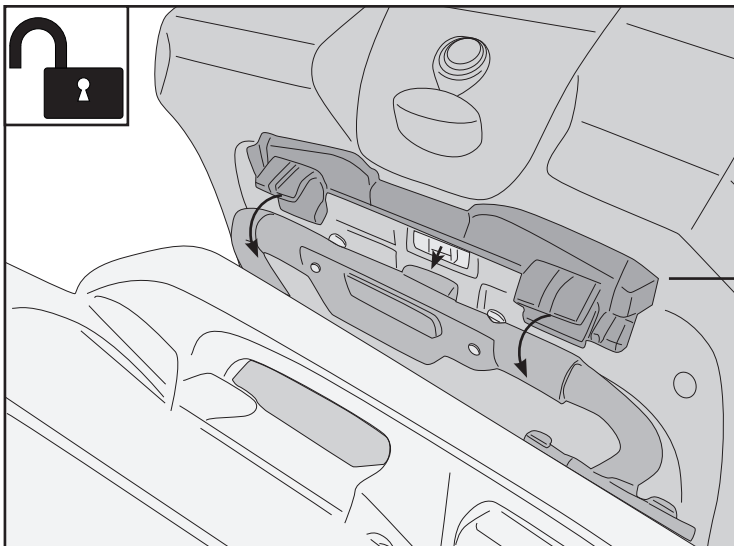
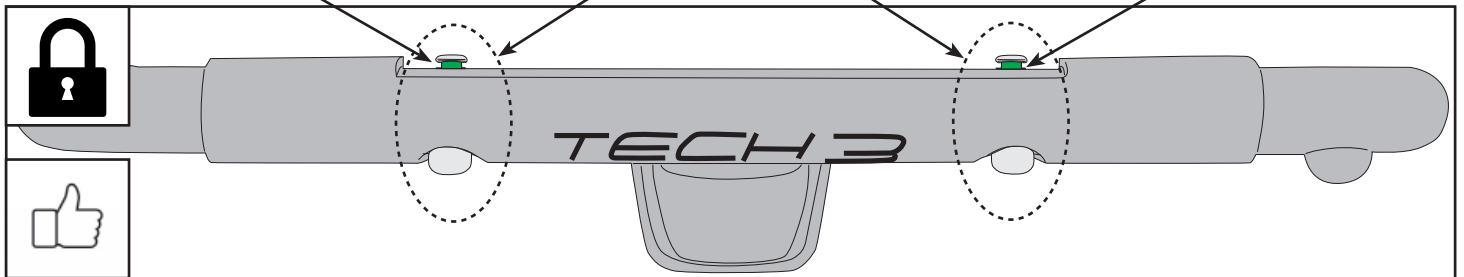

VERDE - GREEN  
VERT - GRÜN  
VERDE - VERDE