

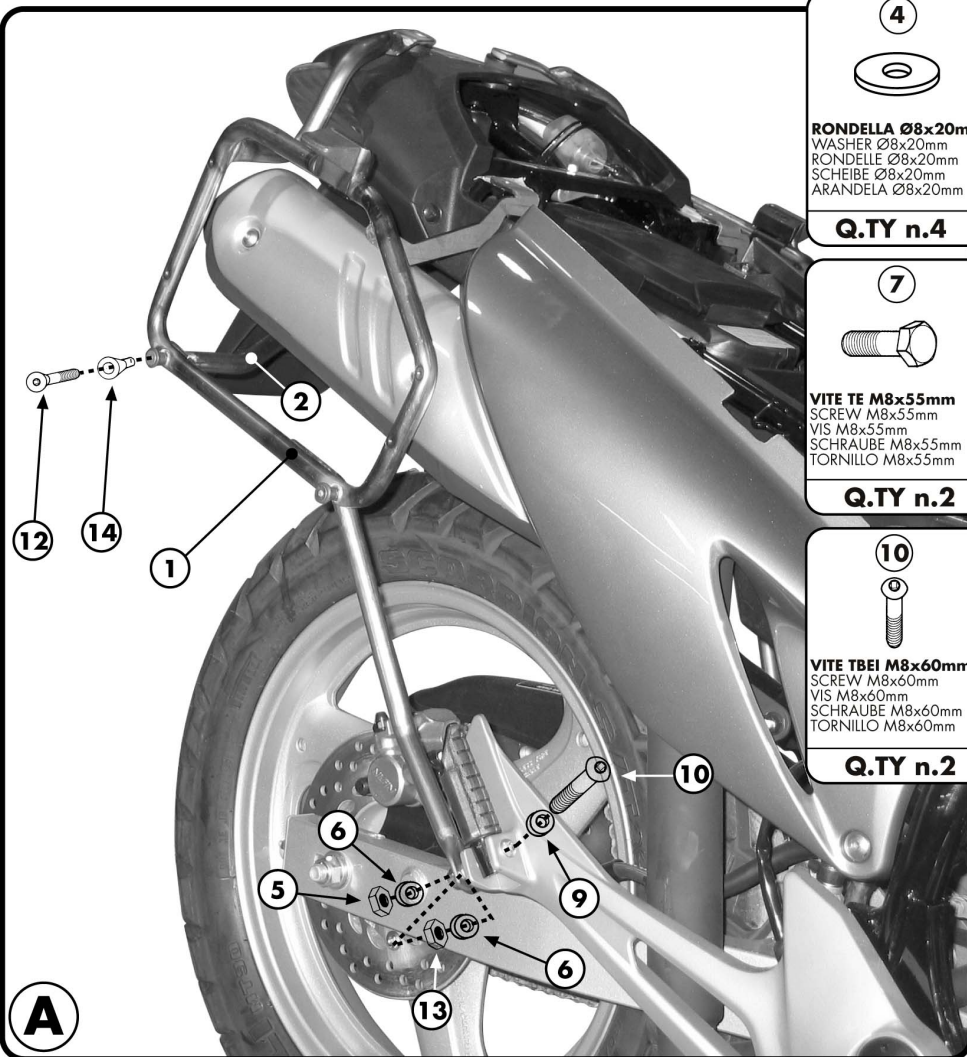

PORTAVALIGIE LATERALE SPECIFICO - SPECIFIC TUBULAR SIDE-CASE HOLDER  
 PORTE-VALISES LATÉRAUX SPÉCIFIQUE - SPEZIFISCHES STAHLROHR-SEITENTRÄGER  
 PORTA-EQUIPAJE LATERAL ESPECIFICO

# HONDA VARADERO 2003 125cc

ISTRUZIONI DI MONTAGGIO - MOUNTING INSTRUCTIONS  
 INSTRUCTIONS DE MONTAGE - BAUANLEITUNG - INSTRUCCIONES DE MONTAJE





1  
  
**Q.TY n.2(dx-sx)**

2  
  
**PONTE POSTERIORE**  
 REAR BRIDGE  
 PONT POSTÉRIEURE  
 VERBINDERUNGSRÖHR  
 PUENTE POSTERIOR  
**Q.TY n.1**

3  
  
**VITE TE M8x35mm**  
 SCREW M8x35mm  
 VIS M8x35mm  
 SCHRAUBE M8x35mm  
 TORNILLO M8x35mm  
**Q.TY n.2**

4  
  
**RONDELLA Ø8x20mm**  
 WASHER Ø8x20mm  
 RONDELLE Ø8x20mm  
 SCHEIBE Ø8x20mm  
 ARANDELA Ø8x20mm  
**Q.TY n.4**

5  
  
**DADO A.B. M8**  
 BOLT M8  
 ECROU M8  
 MUTTER M8  
 TUERCA M8  
**Q.TY n.2**

6  
  
**RONDELLA Ø8**  
 WASHER Ø8  
 RONDELLE Ø8  
 SCHEIBE Ø8  
 ARANDELA Ø8  
**Q.TY n.4**

7  
  
**VITE TE M8x55mm**  
 SCREW M8x55mm  
 VIS M8x55mm  
 SCHRAUBE M8x55mm  
 TORNILLO M8x55mm  
**Q.TY n.2**

8  
  
**RONDELLA Ø9x24**  
 WASHER Ø9x24  
 RONDELLE Ø9x24  
 SCHEIBE Ø9x24  
 ARANDELA Ø9x24  
**Q.TY n.2**

9  
  
**RONDELLA Ø8x14**  
 WASHER Ø8x14  
 RONDELLE Ø8x14  
 SCHEIBE Ø8x14  
 ARANDELA Ø8x14  
**Q.TY n.2**

10  
  
**VITE T8x60mm**  
 SCREW M8x60mm  
 VIS M8x60mm  
 SCHRAUBE M8x60mm  
 TORNILLO M8x60mm  
**Q.TY n.2**

11  
**COMPONENTI ORIGINALI**  
 ORIGINAL PARTS  
 ORIGINAL BAUTEILE  
 PARTIES ORIGINALES  
 COMPONENTES ORIGINALES  
**Q.TY n.-**

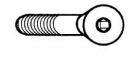
12  
  
**VITE TSCEI M6x35mm**  
 SCREW M6x35mm  
 VIS M6x35mm  
 SCHRAUBE M6x35mm  
 TORNILLO M6x35mm  
**Q.TY n.2**

13  
  
**DADO M8**  
 BOLT M8  
 ECROU M8  
 MUTTER M8  
 TUERCA M8  
**Q.TY n.2**

14  
  
**FUNGHETTO**  
 SIDE SUPPORT  
 CHAMPIGNON  
 KOFFER BEFESTIGUNGST&PSEL  
 BRIDA  
**Q.TY n.2**

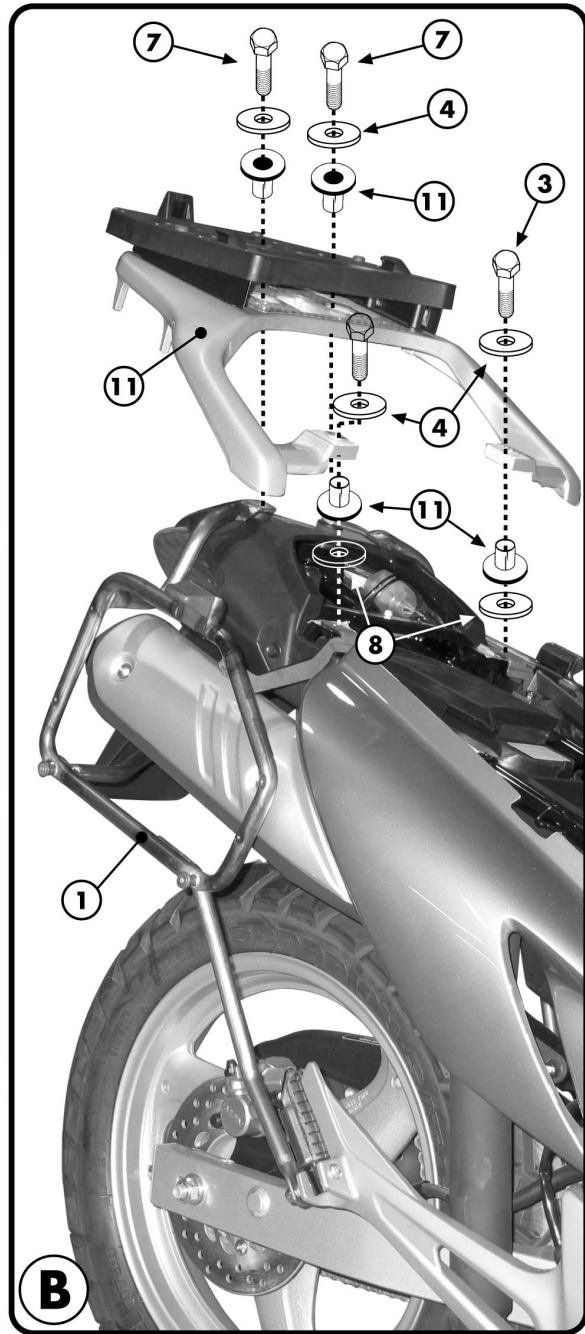

PL173 - KL173

PORTAVALIGIE LATERALE SPECIFICO - SPECIFIC TUBULAR SIDE-CASE HOLDER  
PORTE-VALISES LATÉRAUX SPÉCIFIQUE - SPEZIFISCHES STAHLROHR-SEITENTRÄGER  
PORTA-EQUIPAJE LATERAL ESPECIFICO

**HONDA VARADERO** 2003  
**125cc**

ISTRUZIONI DI MONTAGGIO - MOUNTING INSTRUCTIONS  
INSTRUCTIONS DE MONTAGE - BAUANLEITUNG - INSTRUCCIONES DE MONTAJE

## I ISTRUZIONI DI MONTAGGIO

1. SMONTARE IL PORTAPACCO ORIGINALE;
2. FISSARE IL PARTICOLARE N°1 COME INDICATO IN FOTO A, UNENDO IL LATO DESTRO CON IL LATO SINISTRO NEL MONTAGGIO DEL PONTE POSTERIORE, PARTICOLARE N°2;
3. PER FISSARE IL PORTAVALIGIE LATERALE RIMONTARE IL PORTAPACCHI ORIGINALE, COME MOSTRATO IN FOTO B;
4. ULTIMARE IL MONTAGGIO CONTROLLANDO CHE TUTTE LE VITI SIANO SERRATE BENE.

## GB MOUNTING INSTRUCTIONS

1. REMOVE THE ORIGINAL CASE HOLDER.
2. FIX PART N° 1 AS SHOWN IN PICTURE A, CONNECTING THE RIGHT SIDE WITH THE LEFT SIDE WHILE MOUNTING THE REAR BRIDGE, PART N° 2
3. IN ORDER TO FIX THE SIDE-CASE HOLDER REMOUNT THE ORIGINAL CASE HOLDER, AS SHOWN IN PICTURE B
4. LASTLY CHECK THAT ALL SCREWS HAVE BEEN CORRECTLY TIGHTENED.

## F INSTRUCTIONS DE MONTAGE

1. DEMONTER LE PORTE-PAQUET D'ORIGINE
2. FIXER LES PIÈCES N°1 COMME INDIQUE SUR LA PHOTO A, REUNIR LE CÔTE GAUCHE ET LE CÔTE DROIT AVEC LE PONT POSTÉRIEUR, PIÈCE N°2;
3. POUR FIXER LES SUPPORTS VALISES LATÉRAUX REMONTER LE PORTE-PAQUET D'ORIGINE COMME MONTRE SUR LA PHOTO B;
4. FINIR LE MONTAGE EN CONTROLANT LE BON SERRAGE DE TOUTES LES VIS.

## D BAUANLEITUNG

1. ENTFERNEN SIE DEN ORIGINALGEPÄCKTRÄGER .
2. BEFESTIGEN SIE DAS TEIL NR. 1 WIE IM BILD A BESCHRIEBEN, VERBINDEN SIE DIE RECHTE MIT DER LINKEN SEITE MIT DEM VERBINDUNGSRÖHR,NR. 2.
3. MONTIEREN SIE DEN ORIGINALGEPÄCKTRÄGER WIR IM BILD B BESCHRIEBEN.
4. ZULETZT ÜBERPRÜFEN SIE, DAß ALLE SCHRAUBEN FESTGEZOGEN WURDEN.

ES

## INSTRUCCIONES DE MONTAJE

1. DESMONTAR EL PORTA - EQUIPAJE ORIGINAL
2. ANCLAR EL DETALLE NR 1 COMO INDICA LA FOTO A, UNIENDO EL LADO DERECHO CON EL IZQUIERDO DURANTE EL MONTAJE DEL PUENTE TRASERO, DETALLE NR 2;
3. PARA ANCLAR EL PORTA MALETAS LATERAL VOLVER A MONTAR EL PORTAEQUIPAJE ORIGINAL COMO INDICA LA FOTO B
4. ACABAR APRETANDO TODOS LOS TORNILLOS