

TN362-KN23

PARAMOTORE SPECIFICO - SPECIFIC ENGINE GUARD - PARE-CARTER SPECIFIQUE  
 SPEZIFISCHES STURZBUEGEL - PROTEGEMOTOR ESPECIFICO

# HONDA XRV 750 AfricaTwin

ISTRUZIONI DI MONTAGGIO - MOUNTING INSTRUCTIONS  
 INSTRUCTIONS DE MONTAGE - BAUANLEITUNG - INSTRUCCIONES DE MONTAJE

LATO SINISTRO  
 LEFT SIDE  
 COTE GAUCHE

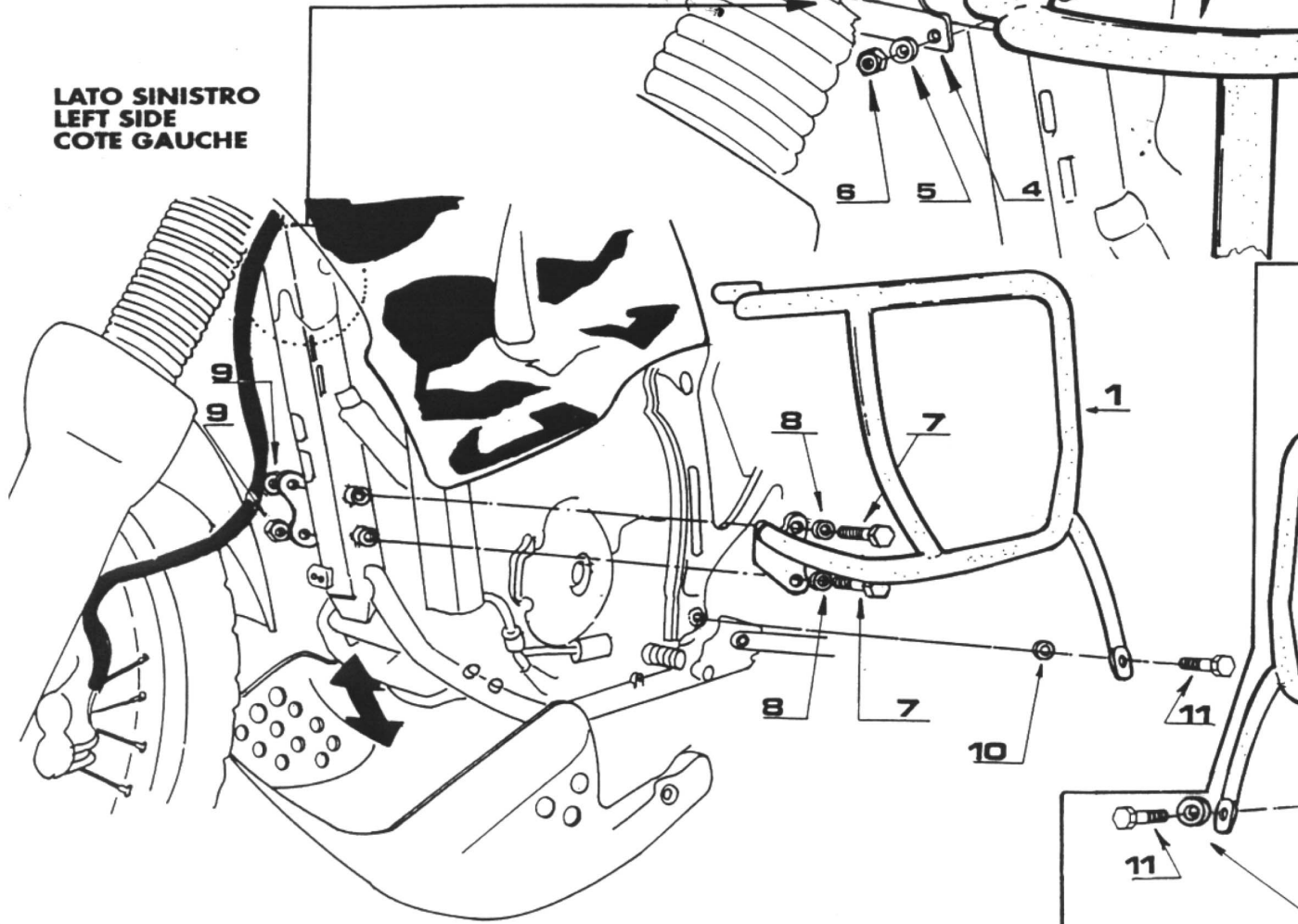

N°	DESCRIZIONE DEL KIT (KIT DESCRIPTION) (DESCRIPTION DU KIT)	QUANTITA' (QUANTITY) (QUANTITE)
1	PARAMOTORE ENGINE GUARD PARA CARTER	2
2	CAVALLOTTO SPECIALE SPECIAL CRAMP CRAMPON SPECIAL	2
3	SUPPORTO SUPPORT SUPPORT	1
4	SUPPORTO SUPPORT SUPPORT	1
5	RONDELLA ø 6 WASHER ø 6 RONDELLE ø 6	4
6	DADO M 6 NUT M 6 ECROU M 6	4
7	VITE TE M 8 X 120 SCREW M 8 X 120 VIS M 8 X 120	2
8	RONDELLA ø 8 WASHER ø 8 RONDELLE ø 8	2
9	DADO ORIGINALE ORIGINAL NUT ECROU ORIGINAL	-
10	RONDELLA ø 10 WASHER ø 10 RONDELLE ø 10	1
11	VITE ORIGINALE ORIGINAL SCREW VIS ORIGINAL	-
12	RONDELLA ø 12 Ø ESTERNO 21 mm WASHER ø 12 RONDELLE ø 12	1

LATO DESTRO  
 RIGHT SIDE  
 COTE DROITE

