

E225M - KE225M

PIASTRA SPECIFICA - SPECIFIC PLATE
 PLATINE SPECIFIQUE - SPEZIFISCHE PLATTE - PARRILLA ESPECIFICA
HONDA XL700V 2008
 TRANSALP

ISTRUZIONI DI MONTAGGIO - MOUNTING INSTRUCTIONS
 INSTRUCTIONS DE MONTAGE - BAUANLEITUNG - INSTRUCCIONES DE MONTAJE

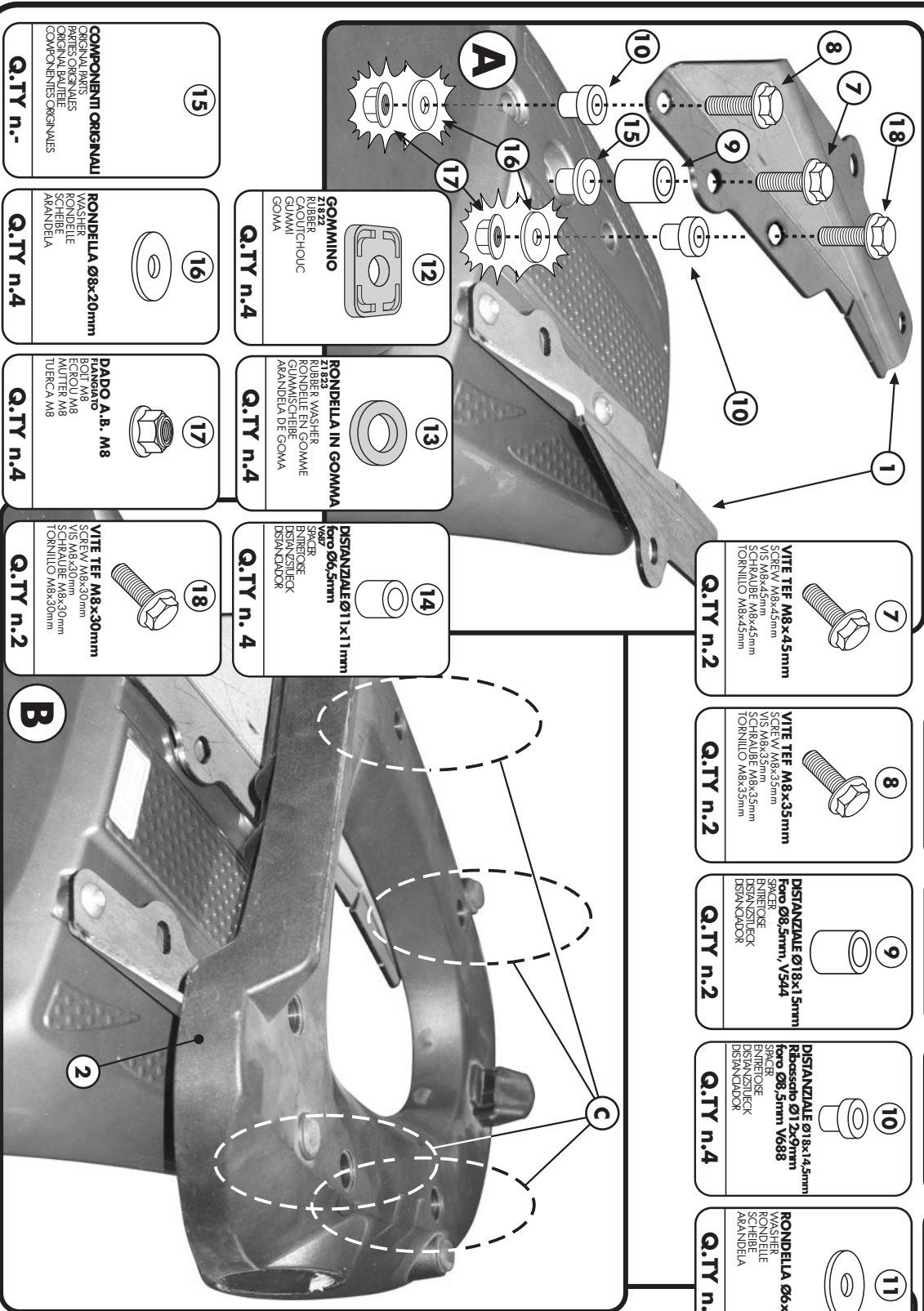

1
SUPPORTO
 SUPPORT
 SUPPORT
 SORTE

2
PIASTRA MONOLOCK
 Z667M
 PLATINE
 PLATINE
 PARRILLA



3
VITE TCEI M6x35mm
 SCREW M6x35mm
 VIS M6x35mm
 SCHRAUBE M6x35mm
 TORNILLO M6x35mm



4
COPRIFORMO
 BOIT CAP
 CACHE TROU
 SICKSLOCK
 TAPA FOSORNO



5
RONDELLA Ø6mm
 WASHER Ø6mm
 RONDELLE Ø6mm
 SCHEIBE Ø6mm
 ARANDELA Ø6mm



6
DADO A.B. M6
 BOIT M6
 ECROU M6
 MUTTER M6
 TUERCA M6

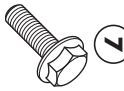

7
VITE TEF M8x45mm
 SCREW M8x45mm
 VIS M8x45mm
 VIS M8x45mm
 SCHRAUBE M8x45mm
 TORNILLO M8x45mm

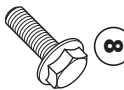

8
VITE TEF M8x35mm
 SCREW M8x35mm
 VIS M8x35mm
 VIS M8x35mm
 SCHRAUBE M8x35mm
 TORNILLO M8x35mm



9
DISTANZIALE Ø18x15mm
 Foro Ø8,5mm, V544
 SPACER
 ENTRETOISE
 DISTANZSTUECK
 DISTANZDADOR



10
DISTANZIALE Ø18x14,5mm
 Recesso Ø12-Ø17mm
 Spacers
 ENTRETOISE
 DISTANZSTUECK
 DISTANZDADOR



11
RONDELLA Ø6x20mm
 WASHER
 WÄNSHER
 RONDELLE
 SCHEIBE
 ARANDELA

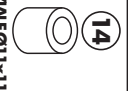
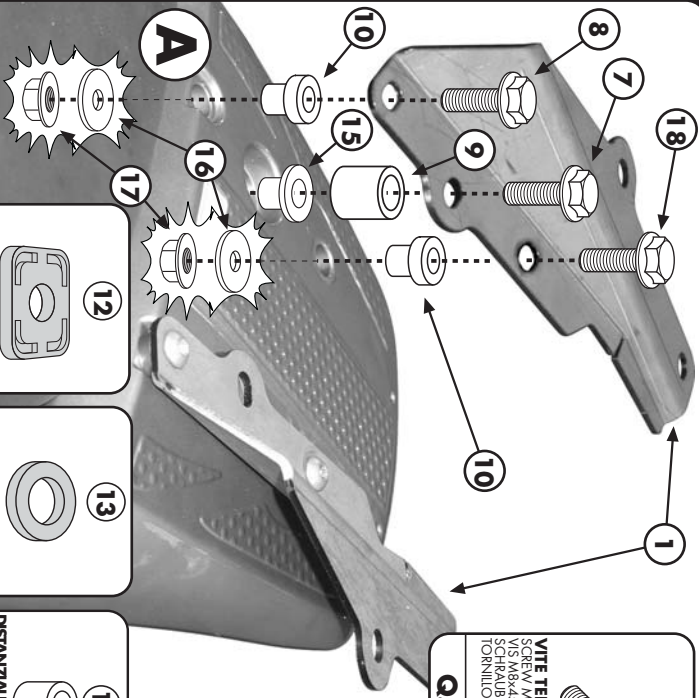

12
GOMMINO
 Z1822
 RIBBER
 RIBBER
 GUMMI
 GOMMA



13
RONDELLA IN GOMMA
 Z1822
 RIBBER
 RIBBER
 GUMMI
 GOMMA



14
DISTANZIALE Ø11x11mm
 Z1822
 RIBBER
 RIBBER
 GUMMI
 GOMMA



15
COMPONENTI ORIGINALI
 ORIGINAL PARTS
 PARTES ORIGINALES
 ORIGINAL BAUTEILE
 COMPONENTES ORIGINALES

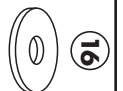

16
RONDELLA Ø8x20mm
 WASHER
 WÄNSHER
 RONDELLE
 SCHEIBE
 ARANDELA



17
DADO A.B. M8
 BOIT M8
 ECROU M8
 MUTTER M8
 TUERCA M8

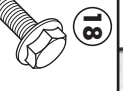

18
VITE TEF M8x30mm
 SCREW M8x30mm
 VIS M8x30mm
 VIS M8x30mm
 SCHRAUBE M8x30mm
 TORNILLO M8x30mm

