

PL203 - KL203

# HONDA XL700V '08 TRANSALP

PORTAVALIGIE LATERALE SPECIFICO - SPECIFIC TUBULAR SIDE-CASE HOLDER  
 PORTE-VALESSES LAT RAUX SP CIFIQUE - SPEZIFISCHES STAHLROHR-SEITENTRÄGER  
 PORTA MALETAS LATERALES ESPECIFICO  
 ISTRUZIONI DI MONTAGGIO - MOUNTING INSTRUCTIONS  
 INSTRUCTIONS DE MONTAGE - BAUANLEITUNG - INSTRUCCIONES DE MONTAJE

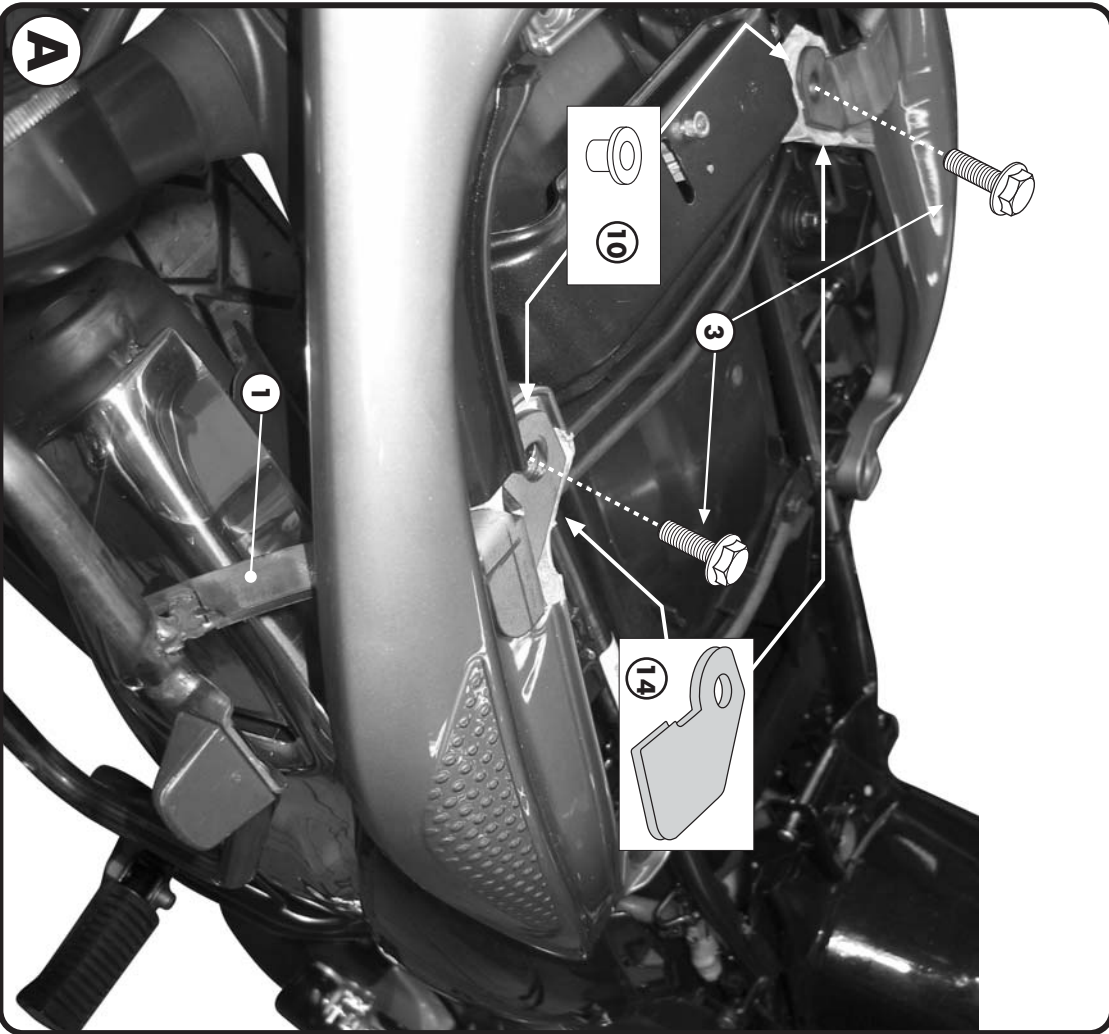

**1**

**SUPPORTO**  
 SUPPORT  
 SUPPORT  
 SUPPORT  
 SUPPORT

**Q.TY n.2(1lx-5x)**

**2**

**PONTE POSTERIORE**  
 REAR BRIDGE  
 PONT POSTERIEUR  
 VERBINDUNGSROHR  
 PUENTE TRASERO

**Q.TY n.1**

**3**

**VITE TEF M8x30mm**  
 SCREW M8x30mm  
 VIS M8x30mm  
 SCHRAUBE M8x30mm  
 TORNILLO M8x30mm

**Q.TY n.2**

**4**

**VITE TCEI M6x20mm**  
 SCREW M6x20mm  
 VIS M6x20mm  
 SCHRAUBE M6x20mm  
 TORNILLO M6x20mm

**Q.TY n.4**

**5**

**VITE TSCEL M6x40mm**  
 SCREW M6x40mm  
 VIS M6x40mm  
 SCHRAUBE M6x40mm  
 TORNILLO M6x40mm

**Q.TY n.2**

**6**

**FUNGHIETTO Z125**  
 SIDE SUPPORT  
 CHAMBRONN  
 KOFFER BEFESTIGUNGSTÜPFEL  
 BMDA

**Q.TY n.2**

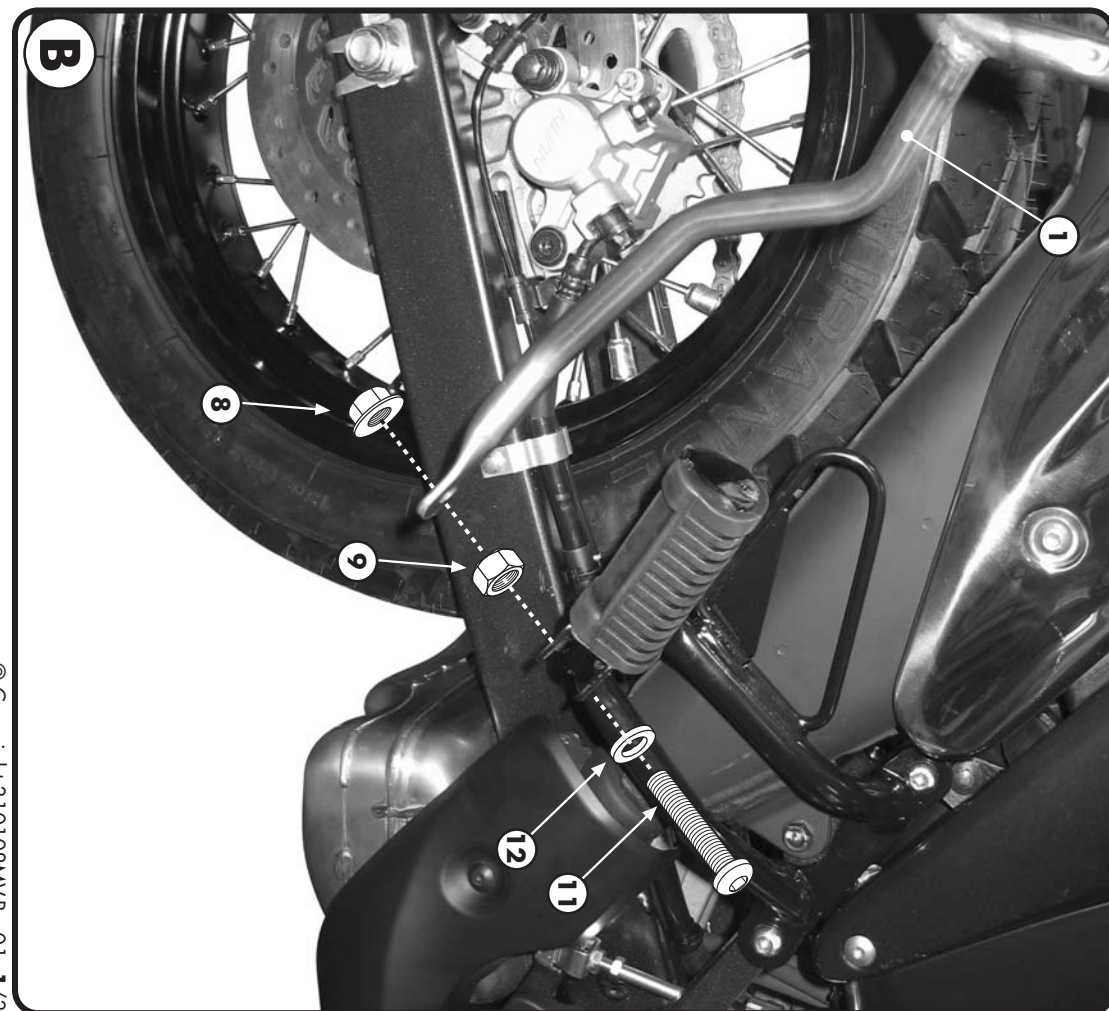

PORTAVALIGIE LATERALE SPECIFICO - SPECIFIC TUBULAR SIDE-CASE HOLDER  
 PORTE-VAISES LAT RAUX SP CIFIQUE - SPECIFISCHES STAHLROHR-SEITENTRÄGER  
 PORTA MALETAS LATERALES ESPECIFICO

# HONDA XL700V '08 TRANSALP

ISTRUZIONI DI MONTAGGIO - MOUNTING INSTRUCTIONS  
 INSTRUCCIONES DE MONTAJE - BAUANLEITUNG - INSTRUCCIONES DE MONTAJE



7

**RONDELLA 616mm**  
 WASHER 60mm  
 RONDELLE 60mm  
 ARANDELA 60mm

Q.TY n.4

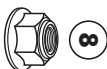

8

**DADO A.B. M8**  
 FLANGIATO  
 BOLT M8  
 ECROU M8  
 MÜTTER M8  
 TUERCA M8

Q.TY n.2



9

**DADO Speciale**  
 V14  
 BOLT M8  
 ECROU M8  
 MÜTTER M8  
 TUERCA M8

Q.TY n.2

10

**COMPONENTI ORIGINALI**  
 ORIGINAL PARTS  
 PARTES ORIGINALES  
 ORIGINAL PARTS  
 COMPONENTES ORIGINALES

Q.TY n.-

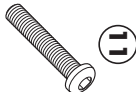

11

**VITE T8E1 M8x55mm**  
 SCREW M8x55mm  
 VIS M8x55mm  
 SCHRAUBE M8x55mm  
 TORNILLO M8x55mm

Q.TY n.2



12

**RONDELLA 68x14mm**  
 WASHER 68x14mm  
 RONDELLE 68x14mm  
 SCHIEBE 68x14mm  
 ARANDELA 68x14mm

Q.TY n.2



13

**DADO A.B. RIB. M6**  
 FLANGIATO  
 BOLT M6  
 ECROU M6  
 MÜTTER M6  
 TUERCA M6

Q.TY n.1



14

**GOMMA SAGOMATA**  
 RUBBER CUSHION  
 CAOUTCHOUC PROFILÉ  
 GEDRUKTE GUMMI  
 GOMMA PROTECTORA

Q.TY n.2

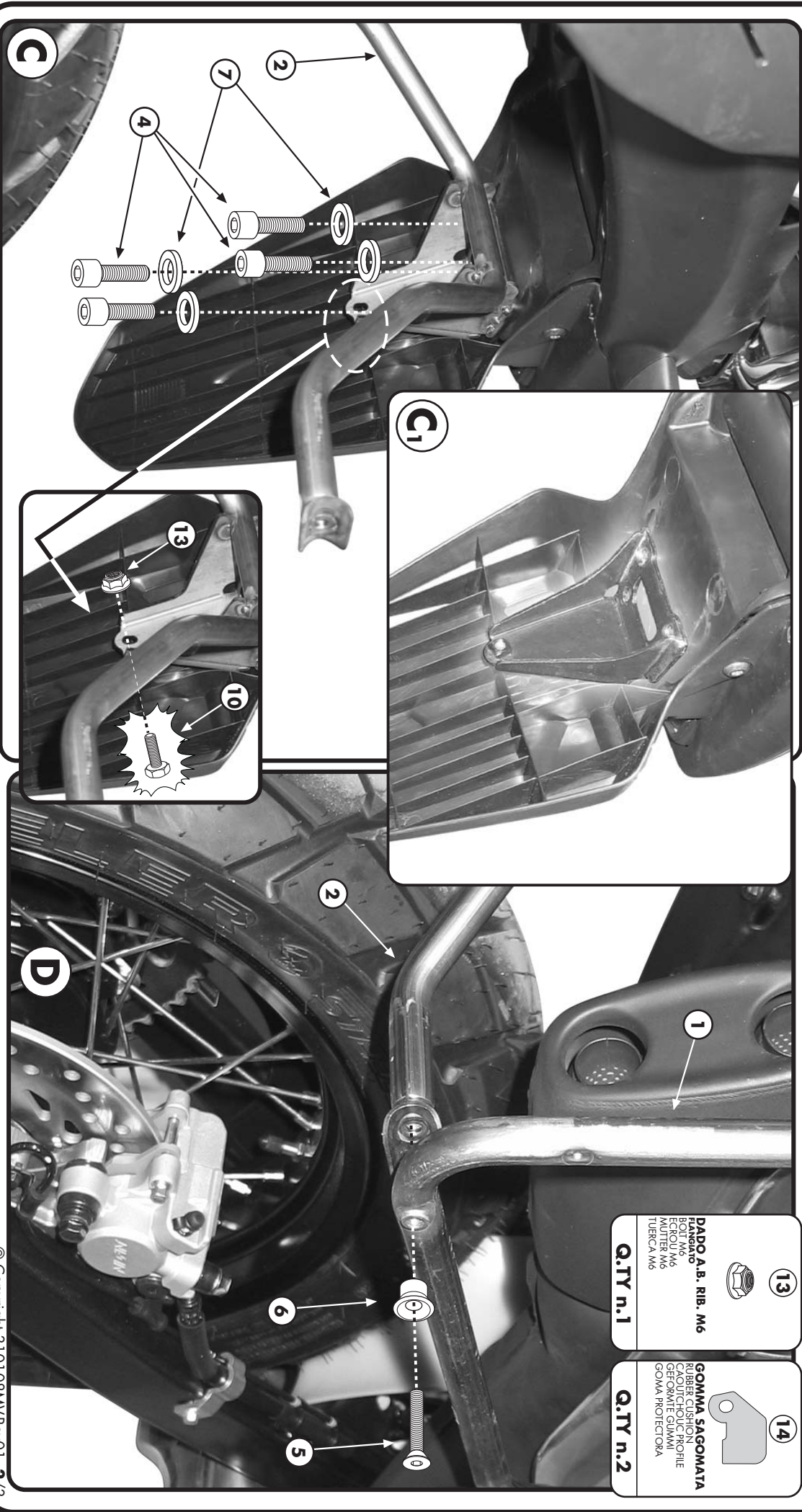



PORTAVALLIGE LATERALE SPECIFICO - SPECIFIC TUBULAR SIDE-CASE HOLDER  
 PORTE-VALISES LAT RAUX SP CHERQUE - SPEZIFISCHES STAHLROHR-SEITENTRÄGER  
 PORTA MALETTAS LATERALES ESPECIFICO

# HONDA XL700V '08 TRANSALP

ISTRUZIONI DI MONTAGGIO - MOUNTING INSTRUCTIONS  
 INSTRUCTIONS DE MONTAGE - BAUANLEITUNG - INSTRUCCIONES DE MONTAJE

## I ISTRUZIONI DI MONTAGGIO

1. MONTARE IL PORTAVALLIGE LATERALE COME INDICATO NELLE IMMAGINI A, B, C, D.
2. IMMAGINE C: NEL MONTAGGIO ILLUSTRATO IN QUESTA IMMAGINE BISOGNA SOSTITUIRE IL PARTICOLARE ORIGINALE EVIDENZIATO IN FOTOGRAFIA C1 CON IL SUPPORTO PONTE POSTERIORE N°2.
3. CONCLUDERE IL MONTAGGIO CONTROLLANDO CHE TUTTE LE VITI SIANO SERRATE BENE (VITI M6=9,6Nm - VITI M8=23Nm).

## GB MOUNTING INSTRUCTIONS

1. REMOVE SEAT AND UNBOLT CARRIER RACK. PLACE SUPPORT BRACKETS (ITEM 1 RIGHT & LEFT) UNDER THE REAR CARRIER AS SHOWN IN PICTURE A USING BOLTS (ITEM 3) AND ORIGINAL PARTS (ITEM 10) TO SECURE THE BRACKETS AND CARRIER IN PLACE.
2. REMOVE FOOT PEG BOLTS AND SECURE THE FRONT MOUNTING POINT OF THE SUPPORT BRACKET (ITEM 1 RIGHT & LEFT) TO THE FOOT PEG USING BOLTS, NUTS AND WASHERS (ITEMS 8, 9, 11 & 12) AS SHOWN IN PICTURE B.
3. UNDERNEATH THE TAIL SECTION REMOVE AND REPLACE THE ORIGINAL BRACKET SHOWN PICTURE C1 WITH REAR BRIDGE BRACKET (ITEM 2) ATTACH USING THE 4 BOLTS (ITEMS 4) AS SHOWN IN PICTURE C.
4. ATTACH SIDE SUPPORT BRACKETS (ITEM 1 RIGHT & LEFT) TO THE BRIDGE BRACKET USING BOLTS AND SPACER (ITEMS 5, 6) THROUGH THE REAR HOLE OF THE SUPPORT, AS SHOWN IN PICTURE D.
5. MAKE SURE ALL BOLTS, NUTS, HARDWARE A SAFELY SECURED AND TIGHTENED. ENJOY YOUR RIDE.

## F INSTRUCTIONS DE MONTAGE

1. MONTER LE PORTE-VALISE LATERAL COMME INDIQUE EN PHOTOS A, B, C ET D.
2. PHOTO C: DANS LE MONTAGE PROPOSE SUR CETTE IMAGE, ON DOIT REMPLACER LA PIECE D'ORIGINE MARQUEE EN PHOTO C1 PAR LE SUPPORT PONT POSTERIEUR N°2.
3. TERMINER LE MONTAGE EN CONTROLANT LE BON SERRAGE DE TOUTES LES VIS (VIS M6=9,6Nm - VIS M8=23Nm)

## D BAUANLEITUNG

1. MONTIEREN SIE DEN SEITENKOFFER TRÄGER WIE IN DEN BILDERN A, B, C, D GEZEIGT.
2. BILD C: BEI DER MONTAGE, DIE IN DIESEM BILD GEZEIGT WIRD, MUSS MAN DAS ORIGINALTEIL (BILD C1) MIT DER HINTEREN HALTERUNG NR. 2 ERSETZEN.
3. ZULETZT ÜBERPRÜFEN SIE DASS ALLE SCHRAUBEN (SCHRAUBEN M6=9,6NM - SCHRAUBEN M8=23NM) FESTGEZOGEN WURDEN.

## ES

## INSTRUCCIONES DE MONTAJE

1. MONTAR EL PORTAMALETAS COMO MUESTRAN LAS FOTOGRAFÍAS A, B, C Y D.
2. FOTOGRAFIA C: EN EL MONTAJE QUE SE MUESTRA EN ESTA PAGINA ES NECESARIO REMPLAZAR LA PIEZA ORIGINAL QUE SE MUESTRA EN LA FOTOGRAFIA C1 POR EL SOPORTE PUENTE TRASERO REFERENCIA N° 02;
3. TERMINAR EL MONTAJE ASEGURÁNDOSE DE QUE TODOS LOS TORNILLOS ESTÉN BIEN APRETADOS.