

# SRL2 for Shoei Helmets Quick Start Guide

ENGLISH

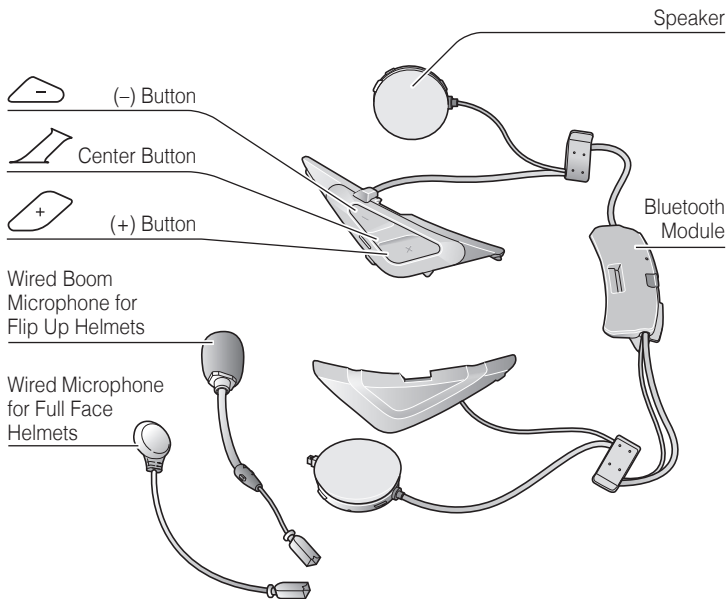

SRL2 compatible SHOEI helmets can be found by scanning the QR code of the product box.

# Ride Connected

Blast your favorite tunes, talk over the intercom with your buddies, hear directions from your GPS and more, all through your headset. With built-in Bluetooth® capabilities, Audio Multitasking™, HD speakers and a microphone using Advanced Noise Control™, technology has never felt so minimal or freeing.



**BLUETOOTH 4.1**



**INTERCOM  
1.6 KM**



**EIGHT-WAY  
INTERCOM**



**CUSTOM  
HELMET FIT**



**AUDIO  
MULTITASKING**



**ADVANCED NOISE  
CONTROL**



**VOICE  
COMMAND**



**MUSIC SHARING**

# Getting Started

1. This product comes with a Quick Start Guide, which is a basic version of the User's Guide. **A FULL VERSION OF THE USER'S GUIDE CAN BE DOWNLOADED AT [SENA.COM](http://SENA.COM).**
2. Update this product for free with the latest firmware to fully enjoy the new advanced features built into this product. Visit [sena.com](http://sena.com) to see how to update your product.
3. Users can follow Sena on Facebook, YouTube, Twitter and Instagram to receive the most up to date information on products, helpful tips and all other announcements regarding Sena products.



**Sena Technologies Co., Ltd.**

Customer Support: [sena.com/support](http://sena.com/support)

# Flip Up Helmet Installation

1

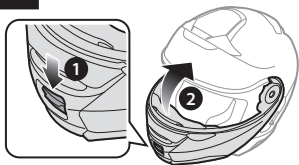

2

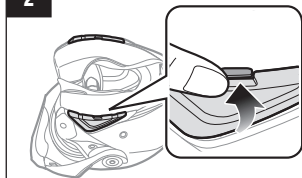

3

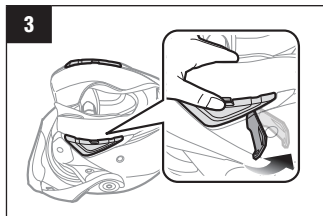

4

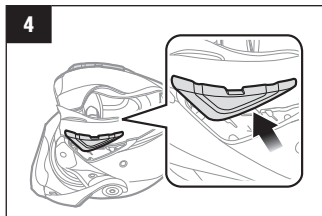

5

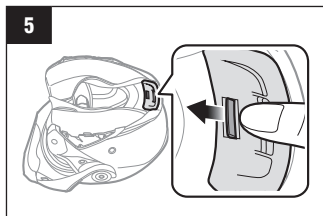

6

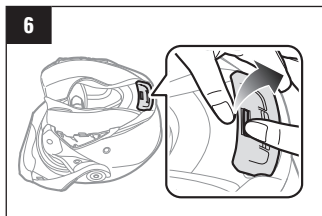

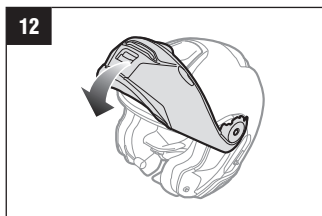
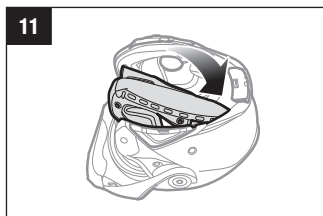
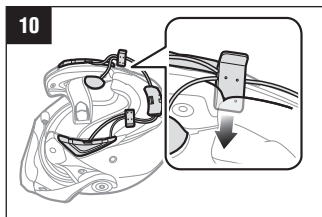
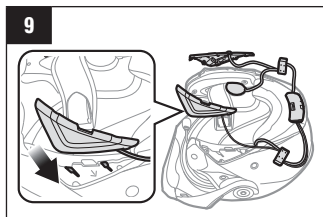
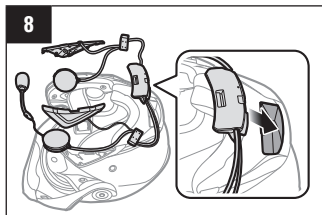
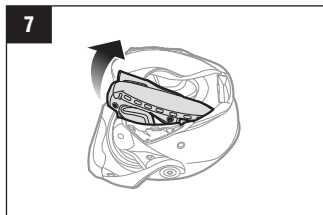

# Full Face Helmet Installation

1

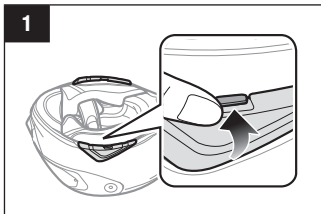

2

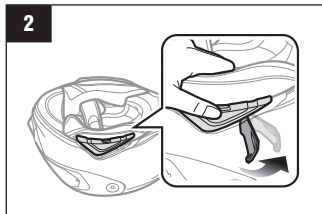

3

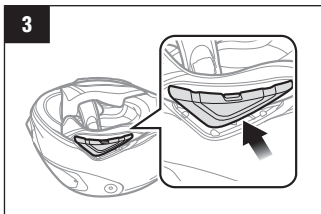

4

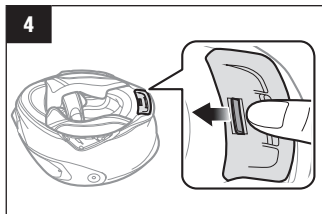

5

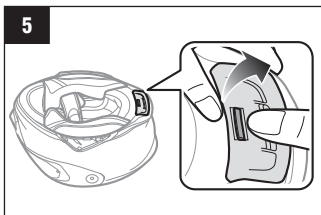

6

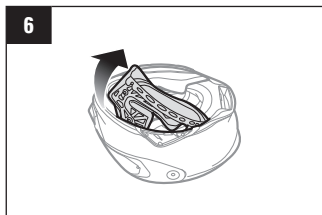

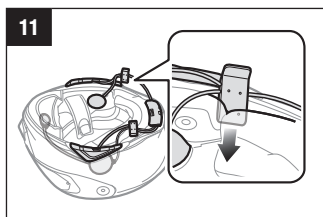
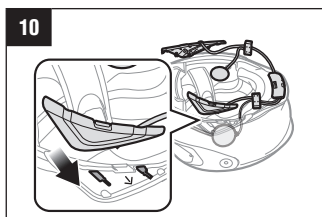
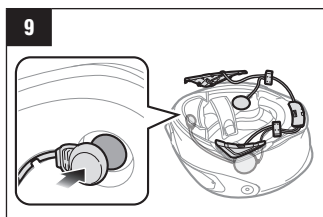
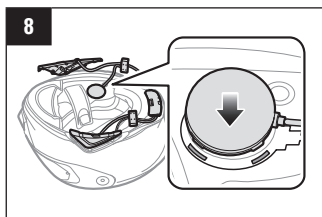
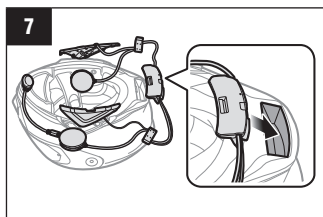

## Sena Motorcycles App

- Download
  - Android: Google Play Store > **Sena Motorcycles**
  - iOS: App Store > **Sena Motorcycles**



## Sena Device Manager

The **Sena Device Manager** allows you to upgrade the firmware and configure its settings directly from your PC or Apple computer. Download the **Sena Device Manager** from [sena.com](http://sena.com).

## Button Operation



Tapping



Double Tapping



Press for 1 sec



Press and Hold



## Power On/Off

### Powering On

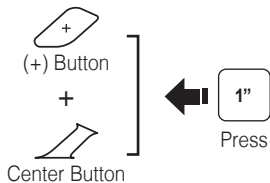

### Powering Off

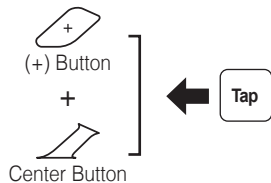

## Volume Adjustment

### Volume Up



### Volume Down



## Bluetooth Pairing Phone, MP3 and GPS

  
Center Button



 12"  
Press



  
(+) Button

 Tap

Select **Sena SRL2** in your mobile phone

  
Status LED 

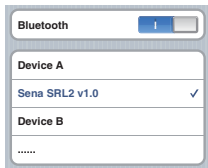

Enter  
0 0 0 0 PIN

## Mobile Phone



**Answer**



Center Button



Tap



**End / Reject**



Center Button



12"

Press



**Voice Dial**



Center Button



12"

Press



**Speed Dial**



(+) Button



12"

Press

## Music



Play / Pause music



Center Button



Press



Track forward



(+) Button



Press



Track backward



(-) Button



Press

## Battery Check



Power On



70 ~ 100%

30 ~ 70%

0 ~ 30%

Status LED



## Configuration Menu



Configuration Menu



Center Button



Press

## Intercom Pairing

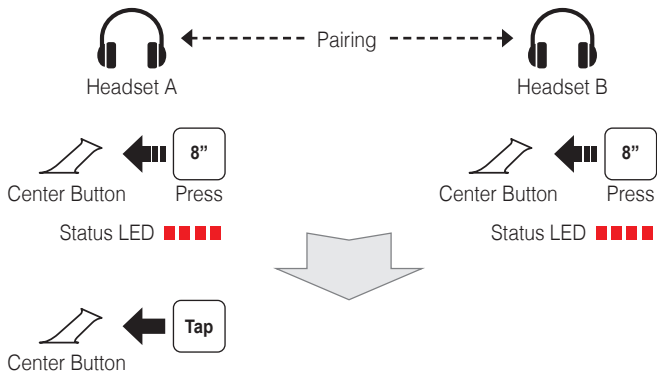

## Start / End Intercom

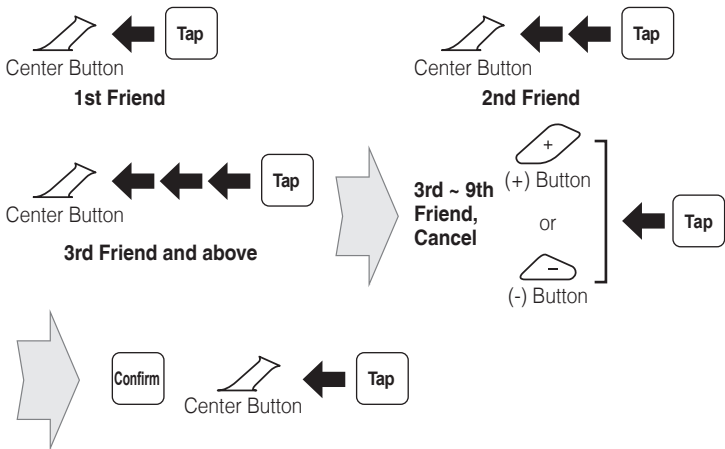

## Start / End Group Intercom

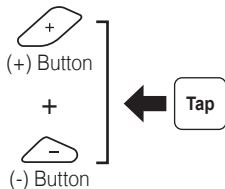

### Note:

You can use Group Intercom after saving your own group in the Sena Motorcycles App. Please refer to the SRL2 User's Guide in more details.

## Radio On / Off

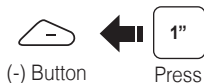

## Radio Seek Station



## Radio Scan Up FM Band

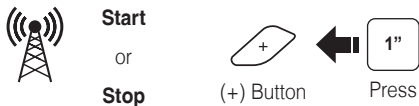

## Save to preset while scanning



# Radio Save and Delete Preset



Center Button



3"

Press



(+) Button

or



(-) Button



Tap

1 ~ 10, Cancel



**Save**



(+) Button



1"

Press

or



**Delete**



(-) Button



1"

Press

## Radio Move to Preset Station

Preset [# + 1]



## Voice Command



"Hello Sena"

or

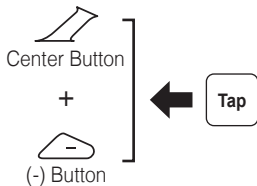

Voice Command	Function
"Music"	Play/Pause music
"FM radio"	FM Radio on/off
"Intercom [one, two, ... , nine]"	Start/End each intercom
"Speed dial [one, two, three]"	Speed dialing

## Troubleshooting

### Factory Reset

If you want to restore the SRL2 to factory default settings, use the Factory Reset in the configuration menu. The headset automatically restores the default settings and turns off.

### Fault Reset

If the SRL2 is not working properly for any reason, reset by gently pushing the pin-hole reset button located next to the DC Power Charging & Firmware Upgrade Port.

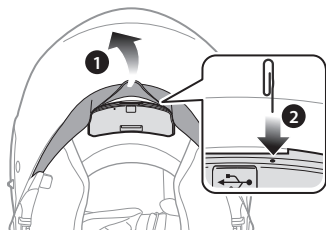

#### Note:

The charging LED is not a pin-hole reset button. Do not press it.

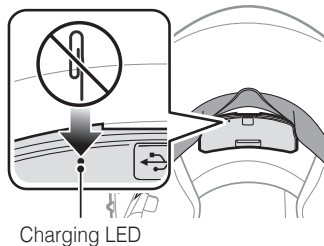



# Quick Reference

Type	Operation	Button Command
Basic Operations	Power on	Press the (+) Button and the Center Button for 1 second
	Power off	Tap the (+) Button and the Center Button
	Volume adjustment	Tap the (+) Button or the (-) Button
	Voice Command	Say "Hello, Sena"
Tap the Center Button and the (-) Button		
Mobile Phone	Answer phone call	Tap the Center Button
	End/Reject phone call	Press the Center Button for 2 seconds
	Voice dial	Press the Center Button for 3 seconds
	Speed dial	Press the (+) Button for 3 seconds
Music	Play/Pause music	Press the Center Button for 1 second
	Track forward	Press the (+) Button for 1 second
	Track backward	Press the (-) Button for 1 second

# Quick Reference

Type	Operation	Button Command
FM Radio	FM radio on/off	Press the (-) Button for 1 second
	Seek forward	Double tap the (+) Button
	Seek backward	Double tap the (-) Button
Intercom	Intercom pairing	Press the Center Button for 8 seconds
		Tap the Center Button
	Start/End intercom	Tap the Center Button
	End all intercoms	Press the Center Button for 5 seconds
	Start group intercom	Tap the (+) Button and the (-) Button
	End group intercom	Tap the (+) Button and the (-) Button