

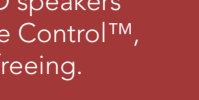

10C EVO

MOTORCYCLE BLUETOOTH® CAMERA AND COMMUNICATION SYSTEM



QUICK START GUIDE

1.3.0

ENGLISH

RIDE CONNECTED

Blast your favorite tunes, talk over the intercom with your buddies, hear directions from your GPS and more, all through your headset. With built-in Bluetooth® capabilities, UHD camera, HD speakers and a microphone using Advanced Noise Control™, technology has never felt so minimal or freeing.

- Bluetooth® Integrated
- 1.6 Km (1.0 Mile) Intercom
- UHD Camera Integrated
- Four-Way Intercom
- Smart Audio Mix™
- Advanced Noise Control™
- WiFi Enabled
- Audio Multitasking™
- Audio Source Priority

GETTING STARTED

- This product comes with a Quick Start Guide, which is a basic version of the User's Guide. **A FULL VERSION OF THE USER'S GUIDE CAN BE DOWNLOADED AT SENA.COM.**
- Update this product for free with the latest firmware to fully enjoy the new advanced features built into this product. Visit sena.com to see how to update your product.
- Users can follow Sena on Facebook, YouTube, Twitter and Instagram to receive the most up to date information on products, helpful tips and all other announcements regarding Sena products.

SENA Sena Technologies, Inc. Customer Support: sena.com

GETTING STARTED

How to Use This Guide

The legend and callouts are here to help you read the illustrations. New technology can be confusing, but we've created a simple way to perform actions using illustrations.

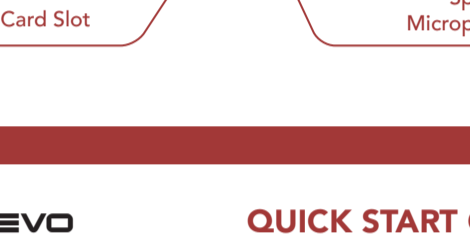

Buttons

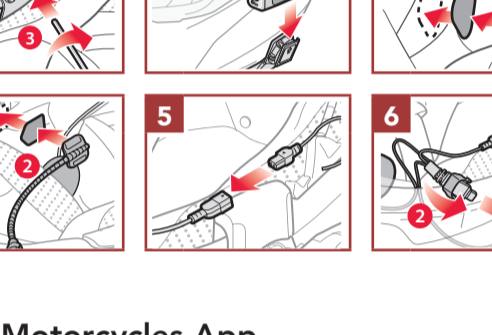

GETTING STARTED

Icon Legend

- Tap button/Jog Dial the specified number of times
- Press and Hold button/Jog Dial for the specified amount of time
- Rotate Jog Dial clockwise (right) or counterclockwise (left).
- Rotate while Pressing Jog Dial clockwise (right) or counterclockwise (left).
- "Hello" Audible prompt

QUICK START GUIDE

Product Details

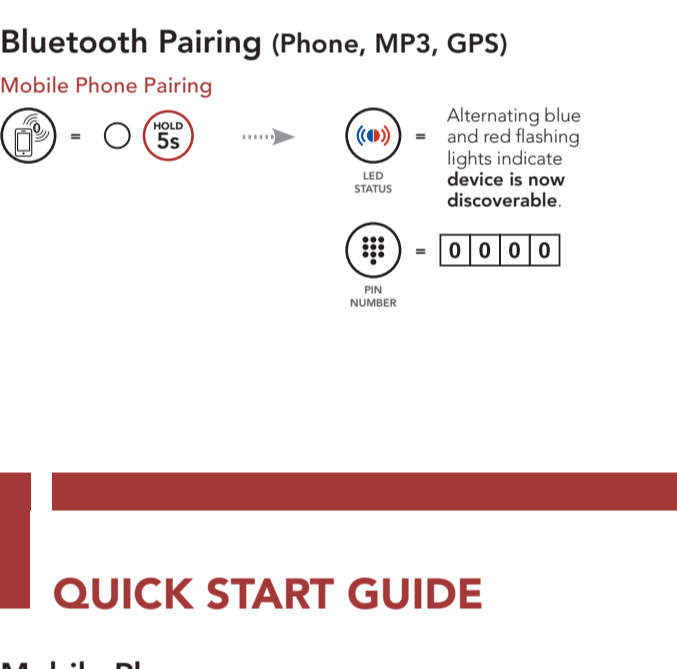

QUICK START GUIDE

Installation



Sena Motorcycles App

- Download
 - Android: Google Play Store > **Sena Motorcycles**
 - iOS: App Store > **Sena Motorcycles**

QUICK START GUIDE

Sena Camera App

The **Sena Camera App** allows you to see a live preview from the camera, manage recorded videos as well as configure the video settings using the built-in WiFi feature on camera system. When the camera and the **Sena Camera App** are connected, the camera is synchronized with the smartphone's date and time. Download the **Sena Camera App** for Android and Apple operating systems from sena.com.

Sena Device Manager

The **Sena Device Manager** allows you to upgrade the firmware and configure its settings directly from your PC or Apple computer. Download the **Sena Device Manager** from sena.com.

Basic Operations

- Powering On**: = (HOLD 1s)
- Powering Off**: = (TAP 1x)
- Volume Up**: = (ROTATE R)
- Volume Down**: = (ROTATE L)

QUICK START GUIDE

Checking the Battery Level

- Visual Method**: = (HOLD 1s). HIGH, MED, LOW indicators.
- Audible Method**: = (HOLD 5s). "Battery level high/medium/low"

Bluetooth Pairing (Phone, MP3, GPS)

- Mobile Phone Pairing**: = (HOLD 5s) → = Alternating blue and red flashing lights indicate device is now discoverable. PIN NUMBER: 0000

QUICK START GUIDE

Mobile Phone

- Answer a Call**: = or (TAP 1x)
- Reject a call**: = (HOLD 2s)
- End a Call**: = (TAP 1x) or (HOLD 2s)
- Make a Call with Voice Dialer**: = (TAP 1x)

Music Controls

- Play/Pause**: = (HOLD 1s)
- Track forward**: = (ROTATE R)
- Track backward**: = (ROTATE L)

QUICK START GUIDE

Camera Controls

- Camera On**: = (TAP 1x)
- Camera Off**: = or (TAP 1x)
- Taking Photos**: = (TAP 1x)
- Note:** If the video resolution is 2160p/30fps, you cannot take a photo during video recording.
- Start Recording**: = (HOLD 1s)
- Stop Recording**: = (HOLD 1s)
- Format SD Card**: = (HOLD 5s). = (TAP 1x)

Change WiFi Channel (Default: 5 GHz)

- = (HOLD 10s)
- = (TAP 1x) - Select 5 GHz
- = (TAP 1x) - Select 2.4 GHz

Note: IF YOUR SMARTPHONE OR REGION DOES NOT SUPPORT 5 GHz, YOU MUST CHANGE THE WIFI CHANNEL TO 2.4 GHz.

QUICK START GUIDE

Intercom

Up to three other people can be paired with the headset for Bluetooth intercom conversations.

- Pairing Headset A with Headset B**: and = (HOLD 5s)
- Start/End Intercom with Headset B**: = (TAP 1x)
- Note:** Flashing blue LED confirms intercoms are paired.

QUICK START GUIDE

Headset Configuration Menu

- Accessing the Headset Configuration Menu**: = (HOLD 10s)
- Execute Menu Options**: = (TAP 1x)
- Navigating Between Menu Options**: = (ROTATE R)
- = (ROTATE L)

Troubleshooting

- Factory Reset**: = (HOLD 10s). Solid red LED. = (TAP 1x)
- Fault Reset**: = (TAP 1x). **Note:** Fault Reset will not restore the headset to factory default settings.

QUICK REFERENCE

| TYPE | OPERATION | BUTTON COMMANDS |
|------------------|-------------------------|---------------------------|
| Basic Operations | Power on / Power off | (HOLD 1s) / (TAP 1x) |
| | Volume up / Volume down | (ROTATE R) or (ROTATE L) |
| | Answer phone call | or (TAP 1x) |
| Mobile Phone | End phone call | (TAP 1x) or (HOLD 2s) |
| | Reject phone call | (HOLD 2s) |
| | Voice dial | (TAP 1x) |
| | Speed dial | (TAP 2x) |

QUICK REFERENCE

| TYPE | OPERATION | BUTTON COMMANDS |
|----------|----------------------|-----------------|
| Music | Play/Pause music | (HOLD 1s) |
| | Track forward | (ROTATE R) |
| | Track backward | (ROTATE L) |
| Camera | Camera On | (TAP 1x) |
| | Camera Off | or (TAP 1x) |
| | Start/Stop recording | (HOLD 1s) |
| Intercom | Taking Photos | (TAP 1x) |
| | Intercom pairing | (HOLD 5s) |
| Intercom | Start/End intercom | (TAP 1x) |