

10U for Arai Full-face Helmets Quick Start Guide

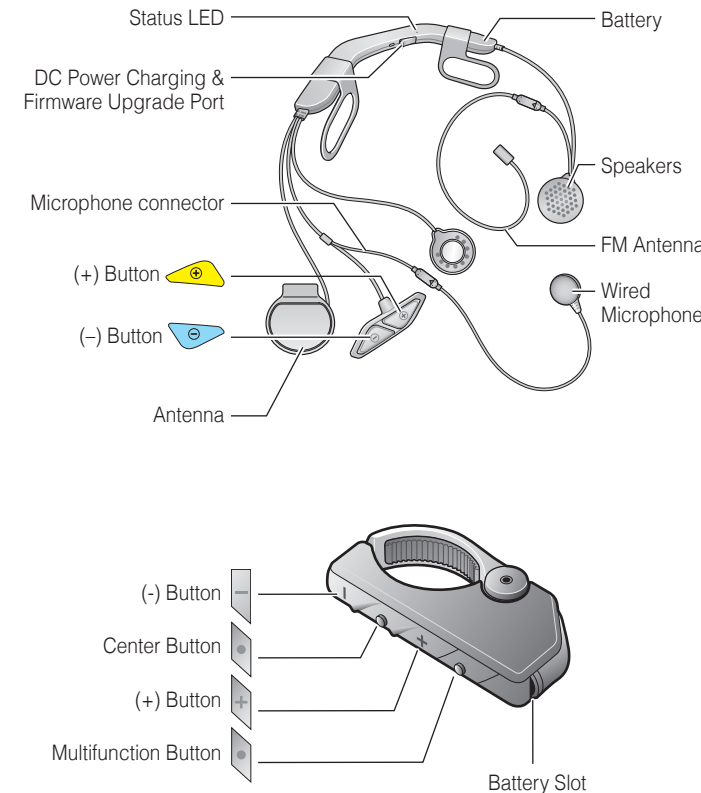

Installation

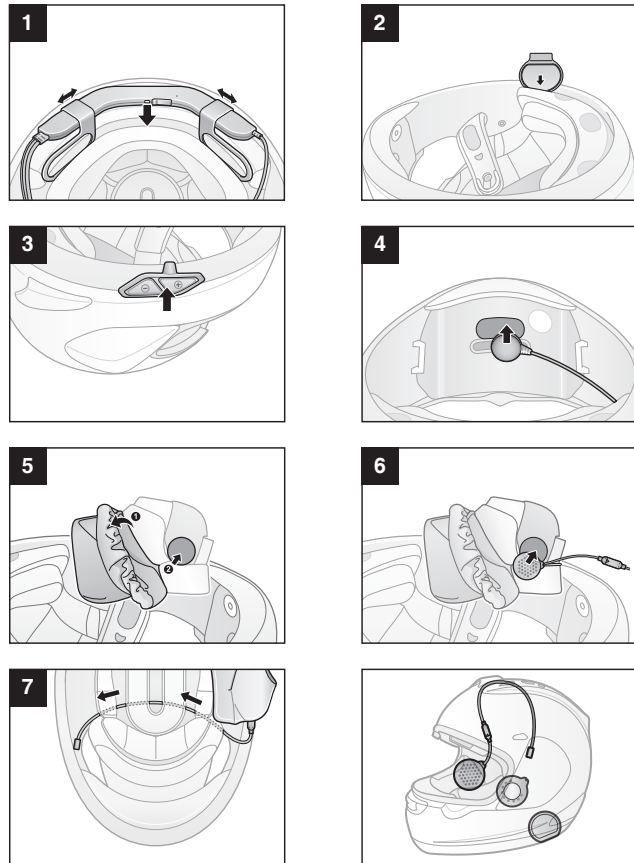

Charging

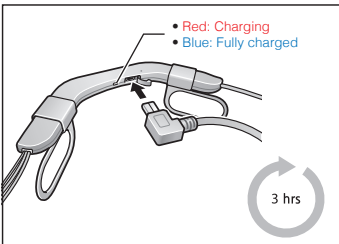

Getting Started

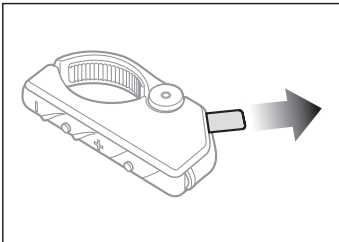

Button Operation

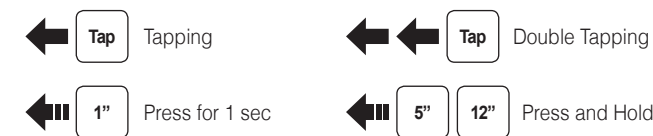

Power On/Off

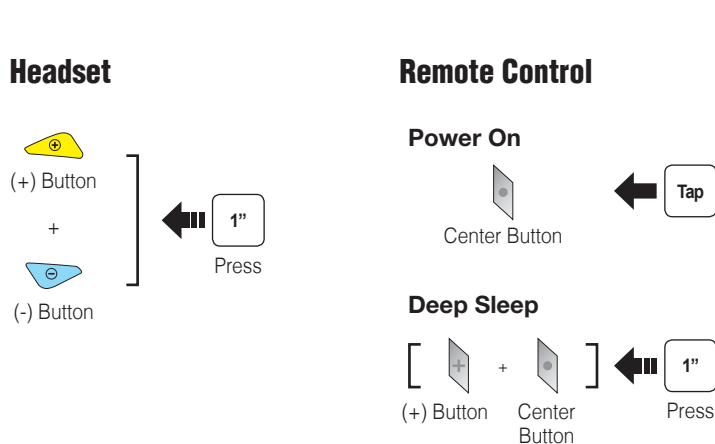

Remote Control Pairing

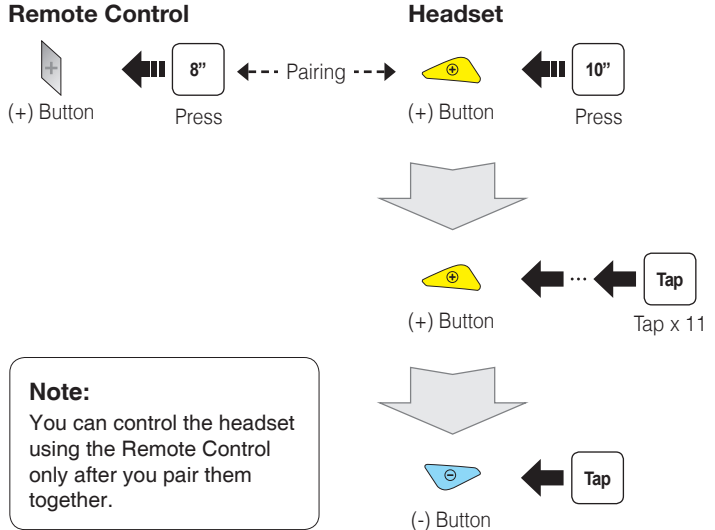

Volume Adjustment

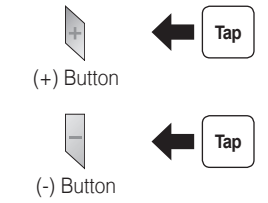

Phone, Music Pairing

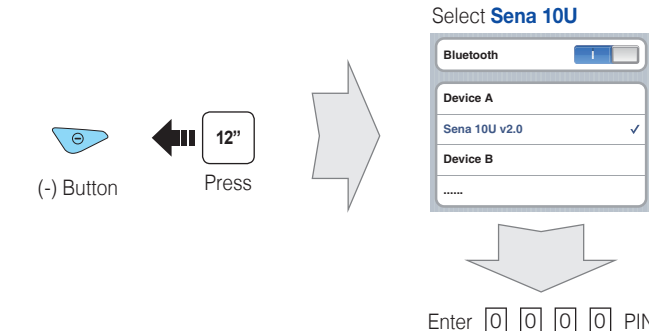

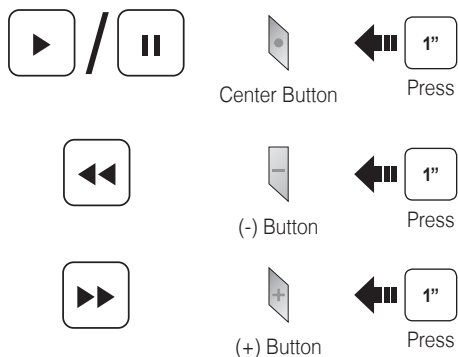

Music Operation





Mobile Phone **Call Making and Answering**



Answer



End



Voice Dial



Speed Dial



Reject



Center Button



Center Button



Center Button



(+) Button



Center Button

Tap



2" Press



3" Press



3" Press



2" Press

Intercom **Pairing**

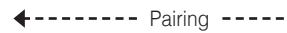

Headset A



Headset B





Center Button



Center Button



Center Button

Center Button



5" Press



5" Press



Tap





Intercom **Start/End**



Center Button



Center Button



Center Button



Center Button



Tap

Double Tap

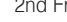

Triple Tap



1st Friend

2nd Friend



3rd Friend

Radio **On/Off**

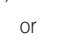

(-) Button

1" Press

Radio **Seek Stations**

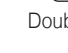

(+) Button
or

(-) Button



Tap

Double Tap

Radio **Scan Up FM Band**

Start
or
Stop

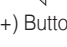
1" Press

(+) Button

Save to preset while scanning

Save

Center Button

Tap

Radio **Move to Preset Station**



Center Button



1" Press



11→12→...151→...191→101

Radio **Save or Delete Preset**



Center Button



3" Press





(+) Button
or

(-) Button



Tap





Save

(+) Button

1" Press

Delete

(-) Button

1" Press

Setting

Configuration Menu

Center Button

10" Press

Using the Sena Device Manager

Connect the headset to your computer via a USB cable. Launch the Sena Device Manager and click **DEVICE SETTING** to configure the headset settings.

For details about downloading the Sena Device Manager, please refer to the leaflet included in the package.

Using the Sena Smartphone App

1. On your smartphone, download the Sena Smartphone App for Android or iPhone from Google Play or App Store. Please refer to www.sena.com for more details.
2. Pair your smartphone with the headset.
3. Run the Sena Smartphone App. Swipe the screen to the right and tap Setting to configure the headset settings.

Troubleshooting

Remote Control Disconnection

If the Remote Control becomes disconnected with your headset, replace the Remote Control's battery or go through the pairing process again. Meanwhile, you can use the headset control buttons to operate the headset. Please refer to the User's Guide at www.sena.com for details on headset control button operations.

Factory Reset





If you want to restore the 10U to factory default settings, use the Factory Reset in the configuration menu. The headset automatically restores the default settings and turns off.

Fault Reset

If the 10U is not working properly for any reason, reset by gently pushing the pin-hole reset button located on the battery.



A full version of the manual is downloadable at www.sena.com.

Sena Technologies, Inc.
www.sena.com
Customer Support: support.sena.com