

SENA

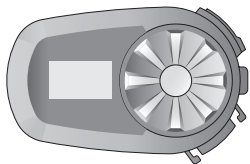

SS

**MOTORCYCLE BLUETOOTH®
COMMUNICATION SYSTEM**

HD SPEAKERS

QUICK START GUIDE

RIDE CONNECTED

Blast your favorite tunes, talk over the intercom with your buddies, hear directions from your GPS and more, all through your Sena 5S headset. With built-in Bluetooth® capabilities, HD speakers and a microphone using Advanced Noise Control™, technology has never felt so minimal or freeing.



Bluetooth® 5.1



Two-way Intercom



Intercom up to 700 m (0.4 mi)*



HD Speakers



Audio Multitasking™

* in open terrain

GETTING STARTED

1. This product comes with a Quick Start Guide, which is a basic version of the User's Guide. **A FULL VERSION OF THE USER'S GUIDE CAN BE DOWNLOADED AT SENA.COM.**
2. Update this product for free with the latest firmware to fully enjoy the new advanced features built into this product. Visit sena.com to see how to update your product.
3. Users can follow Sena on Facebook, YouTube, Twitter and Instagram to receive the most up to date information on products, helpful tips and all other announcements regarding Sena products.

SENA



SENA Technologies, Inc.

Customer Support: sena.com

GETTING STARTED

How to Use This Guide

The legend and callouts are here to help you read the illustrations. New technology can be confusing, but we have created a simple way to perform actions using illustrations.



Buttons

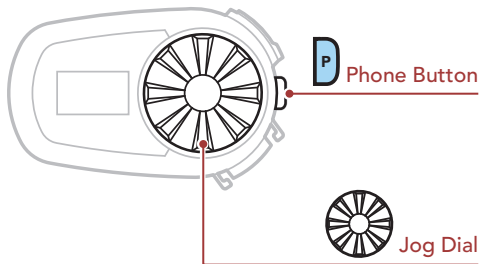

GETTING STARTED

Icon Legend



Tap button/Jog Dial the specified number of times



Press and Hold button/Jog Dial for the specified amount of time



Rotate Jog Dial clockwise (right) or counterclockwise (left).



Rotate while Pressing Jog Dial clockwise (right) or counterclockwise (left).



"Hello"

Audible prompt

QUICK START GUIDE

Product Details

DC Power Charging & Firmware Upgrade Port

LCD Display

Phone Button

Jog Dial

Speaker and Microphone Port

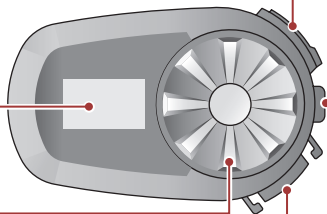

LCD Display

Status

Battery Indicator

Active Function



QUICK START GUIDE

Installation

Using the Clamp Unit

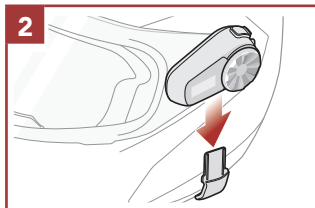
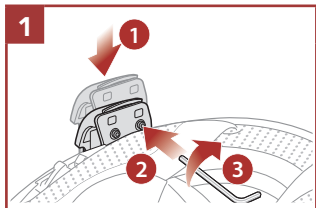

Using the Glued Surface Mounting Plate

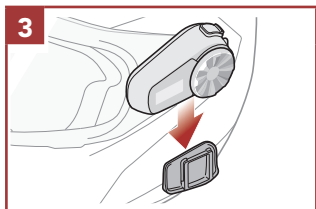
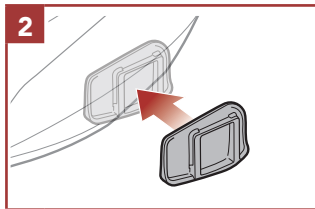
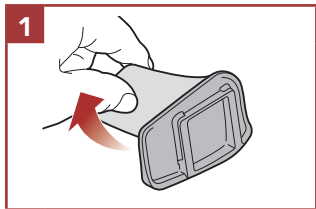

QUICK START GUIDE

Installing the Speakers and the Microphone

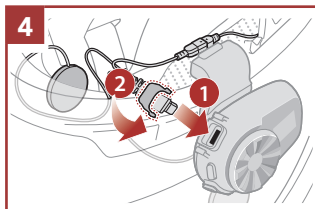
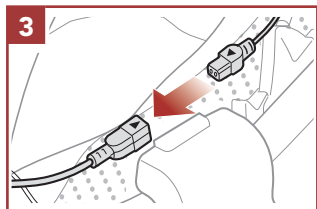
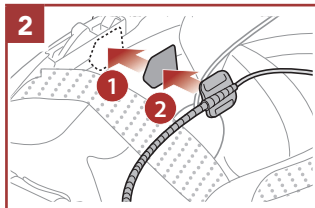
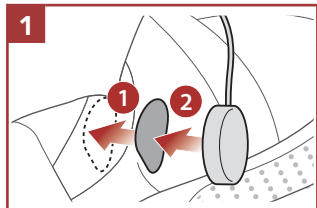

QUICK START GUIDE

SENA MOTORCYCLES App

Download the **SENA MOTORCYCLES App** on **Google Play Store** or **App Store**.



SENA MOTORCYCLES

- Device configuration setting

Sena Device Manager

The **Sena Device Manager** allows you to upgrade the firmware and configure its settings directly from your PC or Apple computer. Download the **Sena Device Manager** from **sema.com**.

NOTICE

- This **Quick Start Guide (Version 2.0)** explains how to operate the 5S with **firmware version 2.0 or higher**.
- For the operation of the 5S with **a firmware version lower than 2.0**, refer to the **5S Quick Start Guide (Version 1.0.0)**.

QUICK START GUIDE

Basic Operations

Powering On

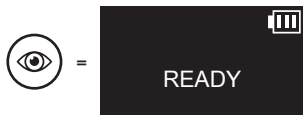

Powering Off



Volume Up



Volume Down



Checking the Battery Level

LCD Display

Battery Indicator

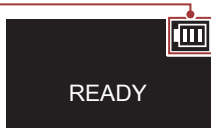

- = High
- = Medium
- = Low
- = Extremely Low

QUICK START GUIDE

Phone Pairing

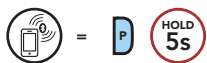

=



With your mobile phone in Bluetooth-pairing mode, select **Sena 5S** in the list of devices detected.



=

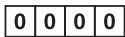

PIN
NUMBER





- For more information on phone pairing, refer to the User's Guide.

QUICK START GUIDE

Mobile Phone

LCD Display



-  = Incoming Call
-  = Outgoing call
-  = On the Phone Call
-  = Reject a call

Answer a Call



End a Call

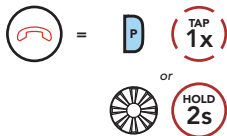

Reject a call



Make Call with Voice Dialer



QUICK START GUIDE

Music Controls

Play/Pause



"[Beep, Beep]"



Track forward



Track backward



QUICK START GUIDE

Bluetooth Intercom

Up to three other people can be paired with the headset for **Bluetooth intercom** conversations.

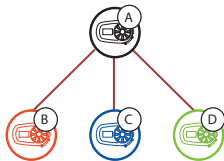



Intercom Pairing

There are two ways to pair the headset.

Using the Smart Intercom Pairing (SIP)

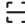
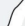
SIP allows you to quickly pair with your friends for intercom communication by scanning the QR code on the **SENA MOTORCYCLES App** without remembering the button operation.

1. Pair the mobile phone with the headset.
2. Open the **SENA MOTORCYCLES App** and tap  (**Smart Intercom Pairing Menu**).
3. Scan the **QR code** displayed on your friend (**B**)'s mobile phone.
 - Your friend (**B**) can display the QR code on the mobile phone by tapping  > **QR code** () on the **SENA MOTORCYCLES App**.

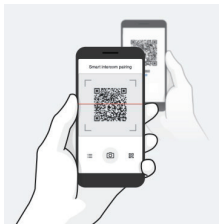

QUICK START GUIDE

4. Tap **Save** and check that your friend **(B)** is paired with **you (A)** correctly.
5. Tap **Scan** (📷) and repeat steps 3-4 to pair with **Intercom Friends (C) and (D)**.

Note: The **Smart Intercom Pairing (SIP)** is not compatible with Sena products that use **Bluetooth 3.0 or below**.

Using the Button

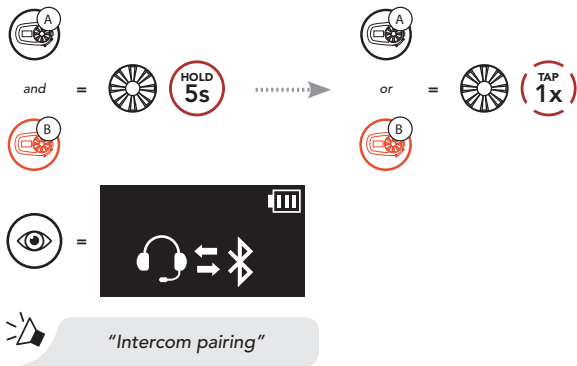

Note: Repeat the step above to pair with Intercom Friends C & D.

QUICK START GUIDE

Last-Come, First-Served

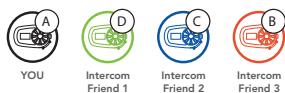

Intercom Conversation with Intercom Friend



Start/End with Intercom Friend 1



Start/End with Intercom Friend 2



Start/End with Intercom Friend 3



QUICK START GUIDE

Configuration Menu

Accessing the Headset Configuration Menu



"Configuration menu"



Execute Menu Options

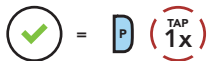

Navigating Between Menu Options



"[Menu prompt]"



"[Menu prompt]"

QUICK START GUIDE

Troubleshooting

Factory Reset

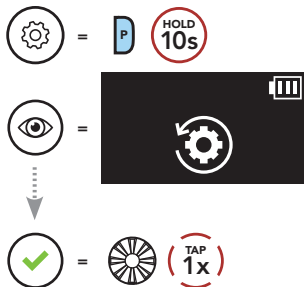



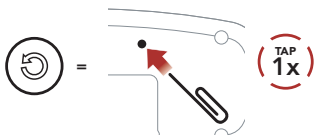

















Fault Reset















Note: Fault Reset will not restore the headset to factory default settings.

QUICK REFERENCE

TYPE	OPERATION	BUTTON COMMANDS
 Basic Operations	Power on / Power off	     
	Volume up / Volume down	  or 
 Mobile Phone	Answer phone call	 
	End phone call	 
	Reject phone call	 
	Speed dial	 
	Make Call with Voice Dialer	 

QUICK REFERENCE

TYPE	OPERATION	BUTTON COMMANDS
 Music	Play/Pause music	 
	Track forward	 
	Track backward	 
 Intercom	Intercom pairing	   
	Start/End intercom	