

RIDE CONNECTED

Blast your favorite tunes, talk over the intercom with your buddies, hear directions from your GPS and more, all through your headset. With built-in Bluetooth® capabilities, UHD camera, HD speakers and a microphone using Advanced Noise Control™, technology has never felt so minimal or freeing.





- Bluetooth® Integrated
- 1.6 Km (1.0 Mile) Intercom
- UHD Camera Integrated
- Four-Way Intercom
- Smart Audio Mix™
- Advanced Noise Control™
- WiFi Enabled
- Audio Multitasking™
- Audio Source Priority

GETTING STARTED

- This product comes with a Quick Start Guide, which is a basic version of the User's Guide. **A FULL VERSION OF THE USER'S GUIDE CAN BE DOWNLOADED AT SENA.COM.**
- Update this product for free with the latest firmware to fully enjoy the new advanced features built into this product. Visit [sena.com](http://sena.com) to see how to update your product.
- Users can follow Sena on Facebook, YouTube, Twitter and Instagram to receive the most up to date information on products, helpful tips and all other announcements regarding Sena products.



Sena Technologies, Inc.  
[sena.com](http://sena.com)  
Customer Support: [support.sena.com](mailto:support.sena.com)



GETTING STARTED

**How to Use This Guide**  
The legend and callouts are here to help you read the illustrations. New technology can be confusing, but we've created a simple way to perform actions using illustrations.

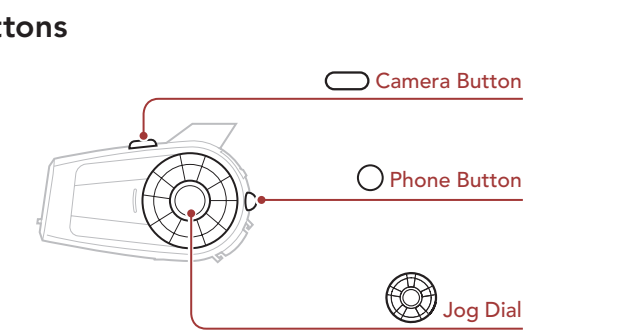

GETTING STARTED

Icon Legend

**TAP 1x** Tap button/Jog Dial the specified number of times

**ROTATE L** **ROTATE R** **ROTATE** Rotate Jog Dial clockwise (right) or counterclockwise (left).

**ROTATE L** **ROTATE R** **ROTATE** Rotate while Pressing Jog Dial clockwise (right) or counterclockwise (left).

**HOLD 10s** Press and Hold button/Jog Dial for the specified amount of time

**"Hello"** Audible prompt

Product Details

Antenna

Camera Button

Lens

Field of view: 125 degrees  
Aperture: F/2.4

DC Power Charging & Firmware Upgrade Port

Phone Button

Speaker and Microphone Port

MicroSD Card Slot

Jog Dial

Status LED

QUICK START GUIDE

Installation

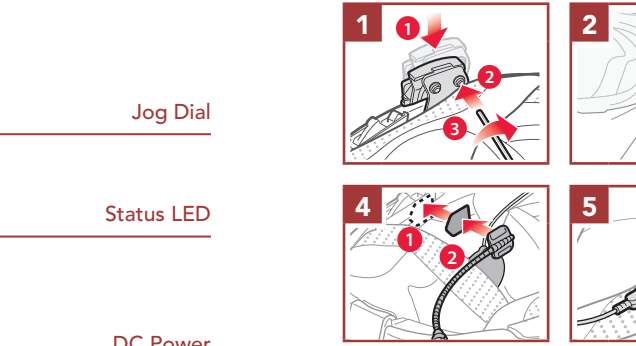

Basic Operations

**Powering On**  
Icon: Power button with a green circle and a red circle with "HOLD 1s".

**Powering Off**  
Icon: Power button with a red circle and a red circle with "TAP 1x".

**Volume Up**  
Icon: Speaker icon with a red circle and a red circle with "ROTATE R".

**Volume Down**  
Icon: Speaker icon with a red circle and a red circle with "ROTATE L".

**Checking the Battery Level**

**Visual Method**  
Icon: Battery level indicator with a green circle and a red circle with "HOLD 1s".

**Audible Method**  
Icon: Speaker icon with a red circle and a red circle with "HOLD 5s".

QUICK START GUIDE

Mobile Phone

**Answer a Call**  
Icon: Phone icon with a green circle and a red circle with "TAP 1x".

**Reject a call**  
Icon: Phone icon with a red circle and a red circle with "HOLD 2s".

**End a Call**  
Icon: Phone icon with a red circle and a red circle with "TAP 1x".

**Make Call with Voice Dialer**  
Icon: Voice dialer icon with a red circle and a red circle with "TAP 1x".

**Music Controls**

**Play/Pause**  
Icon: Play/Pause button with a red circle and a red circle with "HOLD 1s".

**Track forward**  
Icon: Next button with a red circle and a red circle with "ROTATE R".

**Track backward**  
Icon: Previous button with a red circle and a red circle with "ROTATE L".

**Bluetooth Pairing (Phone, MP3, GPS)**

**Mobile Phone Pairing**  
Icon: Bluetooth icon with a red circle and a red circle with "HOLD 5s".

**LED STATUS**  
Icon: LED status icon with a red circle and a red circle with "HOLD 1s".

**PIN NUMBER**  
Icon: PIN number icon with a red circle and a red circle with "HOLD 1s".

QUICK START GUIDE

Camera Controls

**Camera On**  
Icon: Camera icon with a red circle and a red circle with "TAP 1x".

**Camera Off**  
Icon: Camera icon with a red circle and a red circle with "TAP 1x".

**Taking Photos**  
Icon: Camera icon with a red circle and a red circle with "TAP 1x".

**Note:**  
If the video resolution is 2160p/30fps, you cannot take a photo during video recording.

**Format SD Card**  
Icon: SD card icon with a red circle and a red circle with "HOLD 5s".

**Change WiFi Channel (Default: 5 GHz)**  
Icon: WiFi icon with a red circle and a red circle with "HOLD 10s".

**Select 5 GHz**  
Icon: Checkmark icon with a red circle and a red circle with "TAP 1x".

**Select 2.4 GHz**  
Icon: Checkmark icon with a red circle and a red circle with "TAP 1x".

**Note:**  
IF YOUR SMARTPHONE OR REGION DOES NOT SUPPORT 5 GHz, YOU MUST CHANGE THE WIFI CHANNEL TO 2.4 GHz.

**10C EVC**

QUICK START GUIDE

## QUICK START GUIDE

## QUICK START GUIDE

## QUICK START GUIDE

## QUICK START GUIDE

## QUICK START GUIDE

## QUICK START GUIDE

## QUICK REFERENCE

## QUICK REFERENCE

## QUICK REFERENCE

SENA

### Intercom

Up to three other people can be paired with the headset for Bluetooth intercom conversations.

#### Pairing Headset A with Headset B



### Radio

#### FM Radio On



#### Scan Stations



#### FM Radio Off



#### Seek Stations



### Headset Configuration Menu

#### Accessing the Headset Configuration Menu



#### Execute Menu Options



#### Navigating Between Menu Options



### Sena Device Manager

The Sena Device Manager allows you to upgrade the firmware and configure its settings directly from your PC or Apple computer. Download the Sena Device Manager, please visit [sena.com](https://sena.com).

### Sena App

The Sena App allows you to configure the headset settings. Download the Sena App for Android and Apple operating systems from [sena.com](https://sena.com).



### Sena Camera App

The Sena Camera App allows you to see a live preview from the camera, manage recorded videos as well as configure the video settings using the built-in WiFi feature on camera system. When the camera and the Sena Camera App are connected, the camera is synchronized with the smartphone's date and time. Download the Sena Camera App for Android and Apple operating systems from [sena.com](https://sena.com).



### Troubleshooting

#### Factory Reset



#### Fault Reset



**Note:** Fault Reset will not restore the headset to factory default settings.

TYPE	OPERATION	BUTTON COMMANDS
Basic Operations	Power on / Power off	or
	Volume up / Volume down	or
Mobile Phone	Answer phone call	or
	End phone call	or
	Reject phone call	
	Voice dial	
	Speed dial	

TYPE	OPERATION	BUTTON COMMANDS
Music	Play/Pause music	
	Track forward	
	Track backward	
Camera	Camera On	
	Camera Off	
	Start/Stop recording	
	Taking Photos	
FM Radio	FM radio on/off	
	Seek forward	
	Seek backward	
	Scan up FM band/ stop scanning	

TYPE	OPERATION	BUTTON COMMANDS
Intercom	Intercom pairing	or
	Start/End intercom	

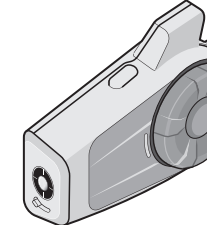

**10C EVO**  
MOTORCYCLE BLUETOOTH® CAMERA  
AND COMMUNICATION SYSTEM

10C EVO

QUICK REFERENCE

1.0.0\_EN\_190627

1.0.0

QUICK START GUIDE

ENGLISH