

**SENA**

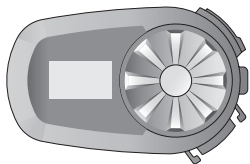

**SS**

**MOTORCYCLE BLUETOOTH®  
COMMUNICATION SYSTEM**

**HD SPEAKERS**

**QUICK START GUIDE**

# RIDE CONNECTED

Blast your favorite tunes, talk over the intercom with your buddies, hear directions from your GPS and more, all through your Sena 5S headset. With built-in Bluetooth® capabilities, HD speakers and a microphone using Advanced Noise Control™, technology has never felt so minimal or freeing.



Bluetooth® 5



Two-way Intercom



Intercom up to 700 m (0.4 mi)\*



HD Speakers



Audio Multitasking™

\* in open terrain

# GETTING STARTED

1. This product comes with a Quick Start Guide, which is a basic version of the User's Guide. **A FULL VERSION OF THE USER'S GUIDE CAN BE DOWNLOADED AT [SENA.COM](http://SENA.COM).**
2. Update this product for free with the latest firmware to fully enjoy the new advanced features built into this product. Visit [sena.com](http://sena.com) to see how to update your product.
3. Users can follow Sena on Facebook, YouTube, Twitter and Instagram to receive the most up to date information on products, helpful tips and all other announcements regarding Sena products.

**SENA**



Sena Technologies Co., Ltd.  
Customer Support: [sena.com](http://sena.com)

# GETTING STARTED

## How to Use This Guide

The legend and callouts are here to help you read the illustrations. New technology can be confusing, but we have created a simple way to perform actions using illustrations.



## Buttons

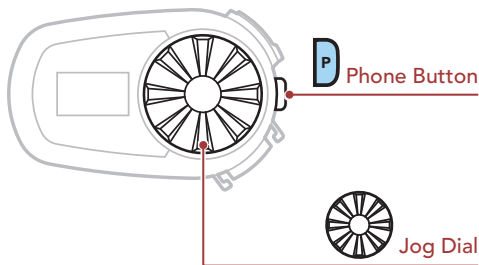

# GETTING STARTED

## Icon Legend



**Tap** button/Jog Dial the specified number of times



**Press and Hold** button/Jog Dial for the specified amount of time



**Rotate** Jog Dial clockwise (right) or counterclockwise (left).



**Rotate while Pressing** Jog Dial clockwise (right) or counterclockwise (left).



"Hello"

**Audible prompt**

# QUICK START GUIDE

## Product Details

DC Power Charging & Firmware Upgrade Port

LCD Display

Phone Button

Jog Dial

Speaker and Microphone Port

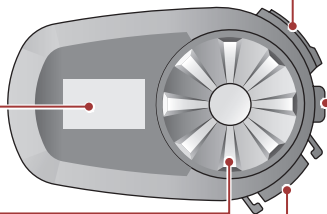

## LCD Display

Status

Battery Indicator

Active Function



# QUICK START GUIDE

## Installation

### Using the Clamp Unit

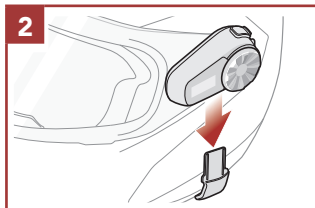
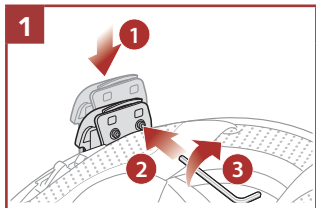

### Using the Glued Surface Mounting Plate

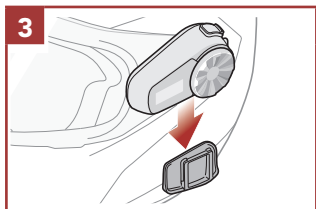
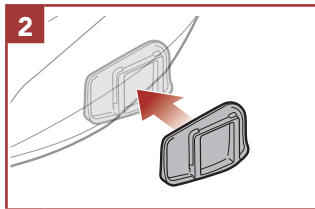
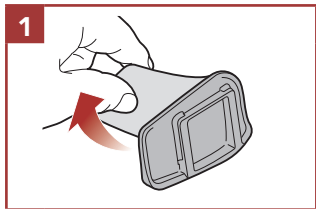

# QUICK START GUIDE

## Installing the Speakers and the Microphone

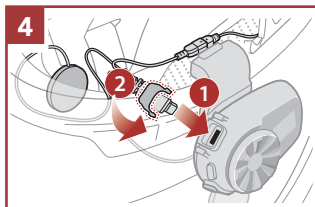
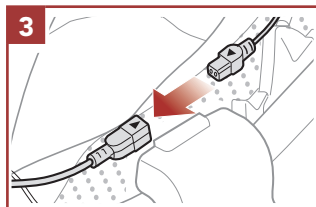
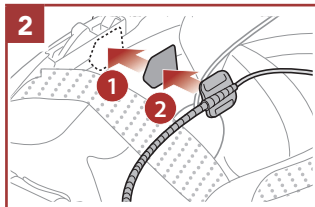
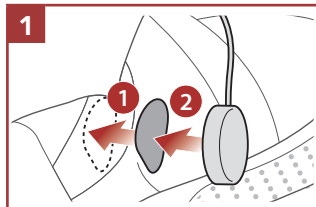



# QUICK START GUIDE

## Sena Motorcycles App

Download the **Sena Motorcycles App** on **Google Play Store** or **App Store**.



### Sena Motorcycles

- Device configuration setting

## Sena Device Manager

The **Sena Device Manager** allows you to upgrade the firmware and configure its settings directly from your PC or Apple computer. Download the **Sena Device Manager** from **[sena.com](http://sena.com)**.

# QUICK START GUIDE

## Basic Operations

### Powering On

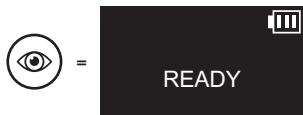

### Powering Off



### Volume Up



### Volume Down



## Checking the Battery Level

### LCD Display

#### Battery Indicator

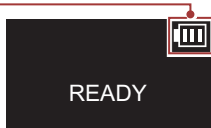

- = High
- = Medium
- = Low
- = Extremely Low

# QUICK START GUIDE

## Phone Pairing

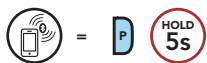

With your mobile phone in Bluetooth-pairing mode, select **Sena 5S** in the list of devices detected.

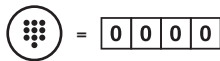

PIN  
NUMBER





- The headset will enter the Phone Pairing mode automatically when you initially turn on the headset.
- For more information on phone pairing, refer to the User's Guide.

# QUICK START GUIDE

## Mobile Phone

### LCD Display



-  = Incoming Call
-  = Outgoing call
-  = On the Phone Call
-  = Reject a call

### Answer a Call



### End a Call

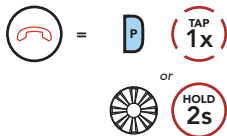

### Reject a call



### Call a Voice Assistant



# QUICK START GUIDE

## Music Controls

### Play/Pause



"[Beep, Beep]"



### Track forward



### Track backward



# QUICK START GUIDE

## Bluetooth Intercom

Up to three other people can be paired with the headset for **Bluetooth intercom** conversations.

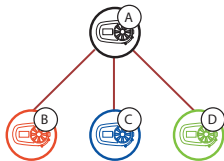



### Intercom Pairing

There are two ways to pair the headset.

#### Using the Smart Intercom Pairing (SIP)

**SIP** allows you to quickly pair with your friends for intercom communication by scanning the QR code on the **Sena Motorcycles App** without remembering the button operation.

1. Pair the mobile phone with the headset.
2. Open the **Sena Motorcycles App** and tap  (**Smart Intercom Pairing Menu**).
3. Scan the **QR code** displayed on your friend (**B**)'s mobile phone.
  - Your friend (**B**) can display the QR code on the mobile phone by tapping  > **QR code** () on the **Sena Motorcycles App**.

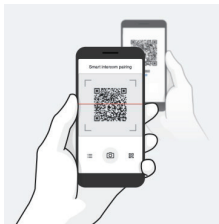

# QUICK START GUIDE

4. Tap **Save** and check that your friend **(B)** is paired with **you (A)** correctly.
5. Tap **Scan** (📷) and repeat steps 3-4 to pair with **Intercom Friends (C) and (D)**.

**Note:** The **Smart Intercom Pairing (SIP)** is not compatible with Sena products that use **Bluetooth 3.0 or below**.

## Using the Button

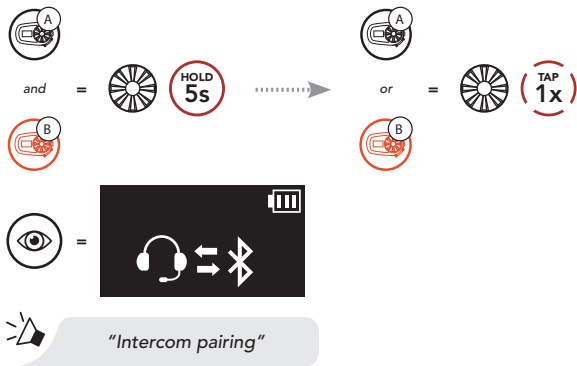

**Note:** Repeat the step above to pair with Intercom Friends C & D.

# QUICK START GUIDE

## Last-Come, First-Served

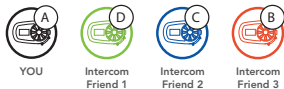

## Intercom Conversation with Intercom Friend



## Start/End with Intercom Friend 1



## Start/End with Intercom Friend 2



## Start/End with Intercom Friend 3





# QUICK START GUIDE

## Configuration Menu

### Accessing the Headset Configuration Menu



"Configuration menu"



### Execute Menu Options

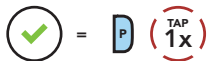

### Navigating Between Menu Options



"[Menu prompt]"



"[Menu prompt]"

# QUICK START GUIDE

## Troubleshooting

### Factory Reset

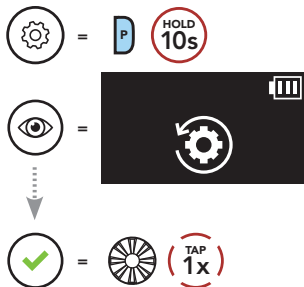



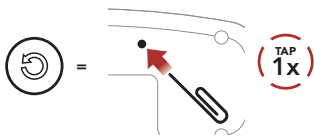

















### Fault Reset















**Note:** Fault Reset will not restore the headset to factory default settings.

# QUICK REFERENCE

TYPE	OPERATION	BUTTON COMMANDS
 Basic Operations	Power on/Power off	  
	Volume up/Volume down	     or 
 Mobile Phone	Answer phone call	 
	End phone call	 
	Reject phone call	 
	Speed dial	 
	Call a Voice Assistant	 

# QUICK REFERENCE

TYPE	OPERATION	BUTTON COMMANDS
 Music	Play/Pause music	 
	Track forward	 
	Track backward	 
 Intercom	Intercom pairing	   
	Start/End intercom	