

# BS PLUS QUICK START GUIDE

ENGLISH

## Boom Microphone Type

Status LED

Pin-hole  
Reset Button

DC Power  
Charging &  
Firmware  
Upgrade Port

 (-) Button

 (+) Button

Microphone

Speakers

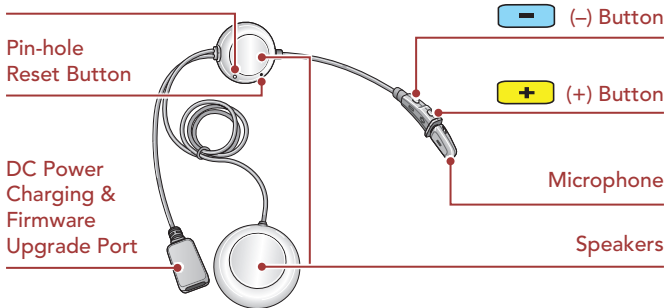

## Universal Microphone Type

Status LED

Pin-hole  
Reset Button

DC Power  
Charging &  
Firmware  
Upgrade Port

 (+) Button

 (-) Button

Microphone Connector

Speakers

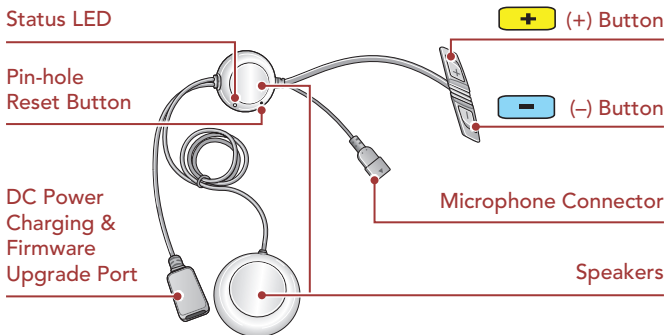

# RIDE CONNECTED



Bluetooth® 5



Two-Way Intercom



Intercom up to 400 m (0.2 mi)\*



Advanced Noise Control™

\* in open terrain

# GETTING STARTED

1. This product comes with a Quick Start Guide, which is a basic version of the User's Guide. **A FULL VERSION OF THE USER'S GUIDE CAN BE DOWNLOADED AT [SENA.COM](http://SENA.COM).**
2. Update this product for free with the latest firmware to fully enjoy the new advanced features built into this product. Visit [sena.com](http://sena.com) to see how to update your product.
3. Users can follow Sena on Facebook, YouTube, Twitter and Instagram to receive the most up to date information on products, helpful tips and all other announcements regarding Sena products.

**SENA**



Sena Technologies Co., Ltd.  
Customer Support: [sena.com](http://sena.com)

# GETTING STARTED

## How to Use This Guide

The legend and callouts are here to help you read the illustrations. New technology can be confusing, but we've created a simple way to perform actions using illustrations.

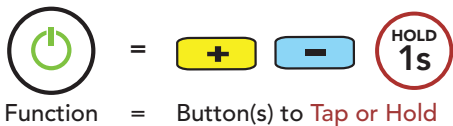

## Icon Legend

**TAP 1x** Tap button the specified number of times

**HOLD 10s** Press and Hold button for the specified amount of time



"Hello"

Audible prompt

## Buttons

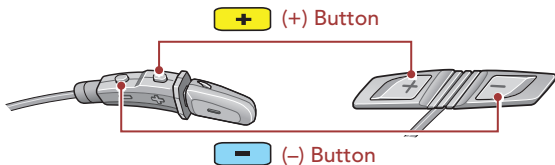

Boom Microphone Type

Universal Microphone Type

# QUICK START GUIDE

## Installation

### Boom Microphone Type

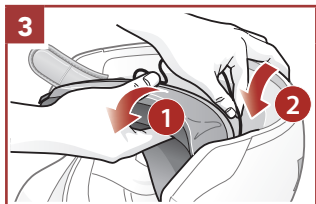
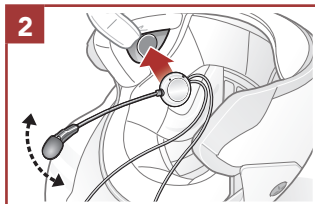
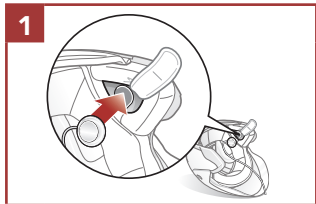

# QUICK START GUIDE

## Universal Microphone Type

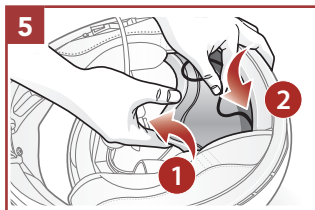
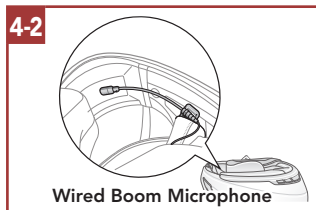
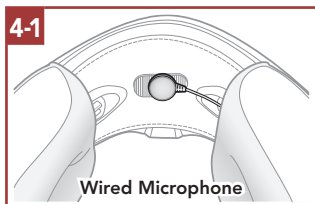
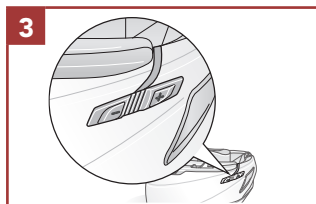
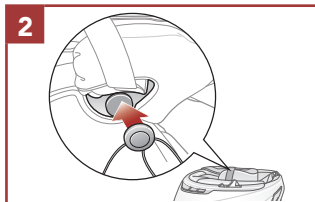
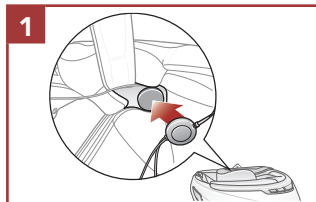

# QUICK START GUIDE

## Sena Motorcycles App

Download the **Sena Motorcycles App** on **Google Play Store** or **App Store**.



### Sena Motorcycles

- Device configuration setting

## Sena Device Manager

The **Sena Device Manager** allows you to upgrade firmware and configure settings directly from your PC. Download the **Sena Device Manager** from **sena.com**.

# QUICK START GUIDE

## Basic Operations

Power On



Power Off



Volume Up



Volume Down



## Checking the Battery Level

Instruction is for when powering the headset on.

Visual Method





# QUICK START GUIDE

## Phone Pairing

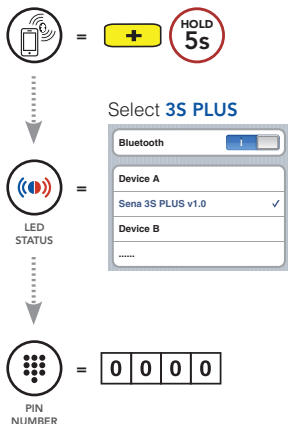

- The headset will enter the Phone Pairing mode automatically when you initially turn on the headset.
- For more information on phone pairing, refer to the User's Guide.

# QUICK START GUIDE

## Mobile Phone

Answer a Call



End a Call



Reject a call



Redial Last Number



Make a Call with the Voice Dialer



## Music Controls

Play/Pause



Next Track



Previous Track



# QUICK START GUIDE

## Bluetooth Intercom

The **3S PLUS** can be paired with another headset for Bluetooth intercom conversation.





### Intercom Pairing

There are two ways to pair the headset.

#### Using the Smart Intercom Pairing (SIP)

**SIP** allows you to quickly pair with your friends for intercom communication by scanning the QR code on the **Sena Motorcycles App** without remembering the button operation.

1. Pair the mobile phone with the headset.
2. Open the **Sena Motorcycles App** and tap  (**Smart Intercom Pairing Menu**).
3. Scan the **QR code** displayed on your friend (**B**)'s mobile phone.
  - Your friend (**B**) can display the QR code on the mobile phone by tapping  > **QR code** () on the **Sena Motorcycles App**.

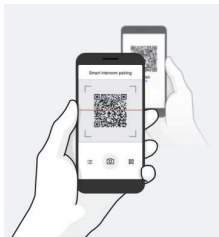

# QUICK START GUIDE

4. Tap **Save** and check that your friend (**B**) is paired with **you (A)** correctly.

**Note:** The **Smart Intercom Pairing (SIP)** is not compatible with Sena products that use **Bluetooth 3.0** or **below**.

## Using the Button

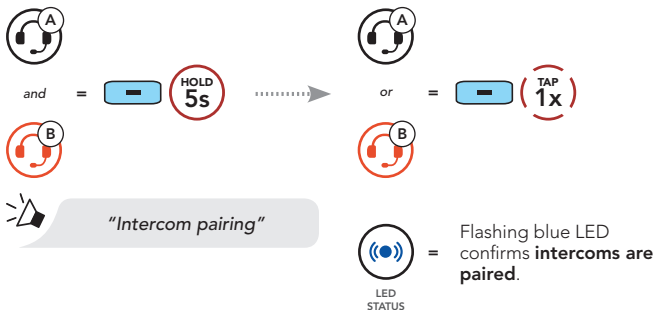

## Start/End Conversation with Intercom Friend

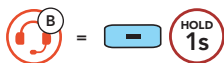

# QUICK START GUIDE

## Configuration Menu

Access the Configuration Menu

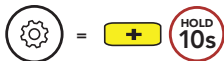

Navigate Between Menu Options

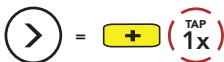

Execute Menu Options

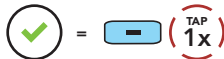

## Troubleshooting

Factory Reset

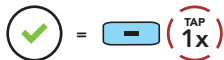
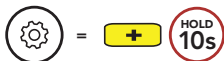



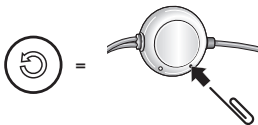















Fault Reset















Press the **Pin-hole Reset Button** for a second with light pressure. The headset will automatically be turned off and a fault reset will occur.

**Note:** **Fault Reset** will not restore the headset to the factory default settings.

# QUICK REFERENCE

TYPE	OPERATION	BUTTON COMMANDS
 Basic Operations	Power on	  
	Power off	  
	Volume up/down	 or  
 Mobile Phone	Answer a call	 
	End a call	 
	Reject a call	 
	Voice dial	 

# QUICK REFERENCE

TYPE	OPERATION	BUTTON COMMANDS
 Music	Play/Pause music	 
	Next track	 
	Previous track	 
 Intercom	Intercom pairing	   
	Start/End intercom	