

Guide de démarrage rapide SMH5 MultiCom

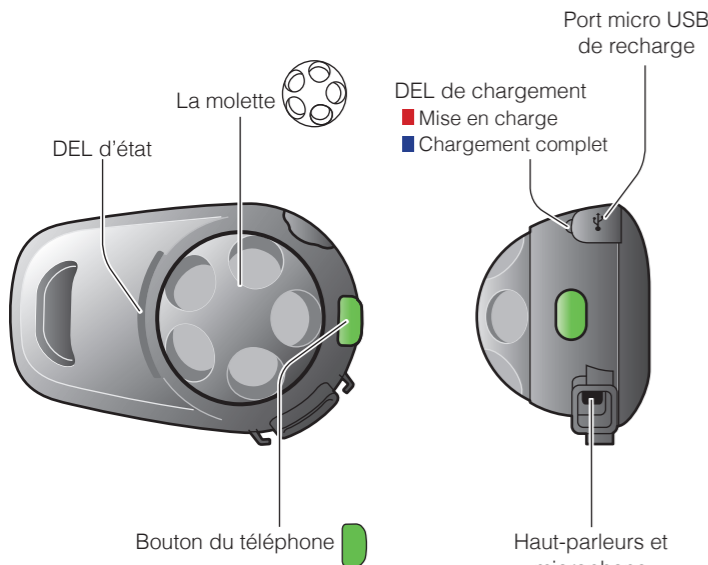

La version complète du manuel peut être téléchargée sur www.sena.com/fr.



Installation

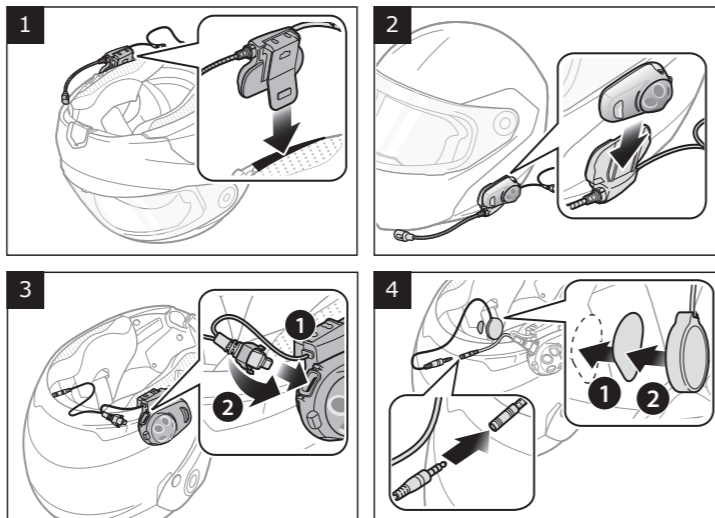

Fonctionnement des boutons



Marche/Arrêt

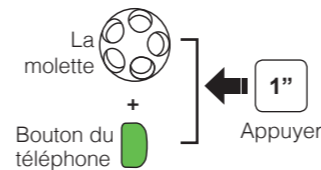

Réglage du volume

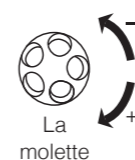

Couplage Bluetooth Téléphone, MP3 et GPS

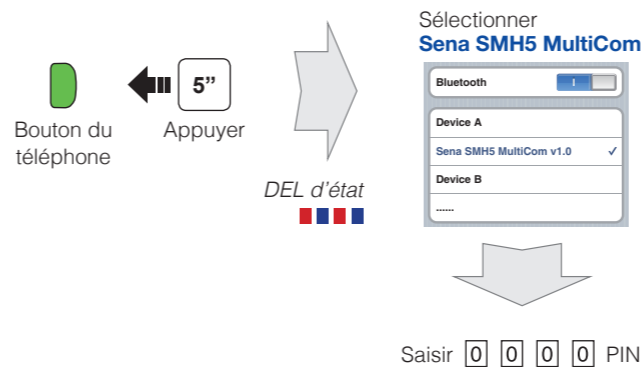

Téléphone mobile

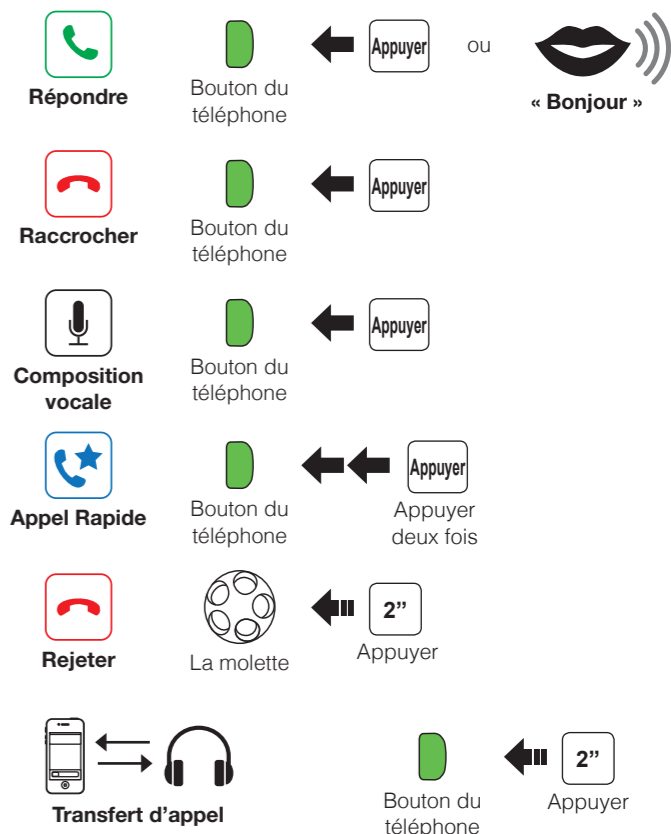

Musique

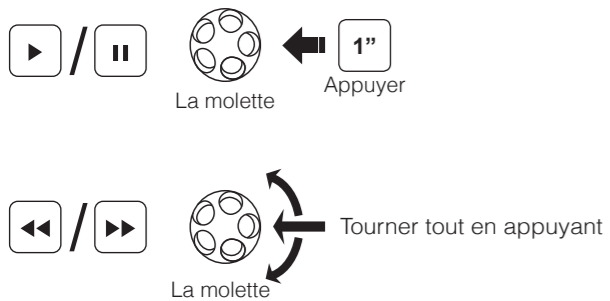

Vérification de la batterie

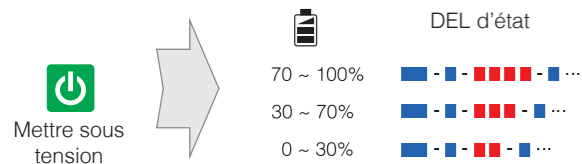

Couplage casque audio Intercom

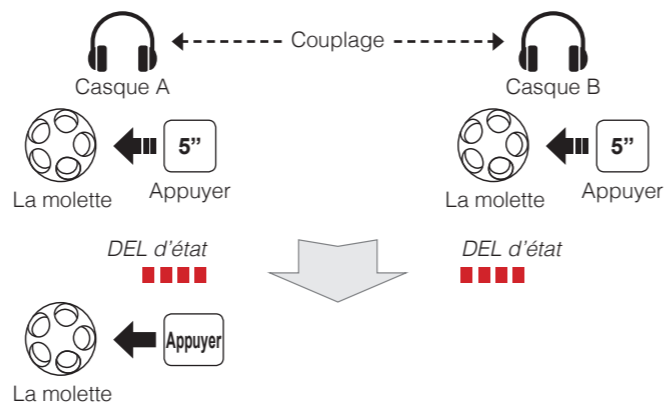

Couplage avec un casque Bluetooth Intercom (dernier arrivé, premier servi)

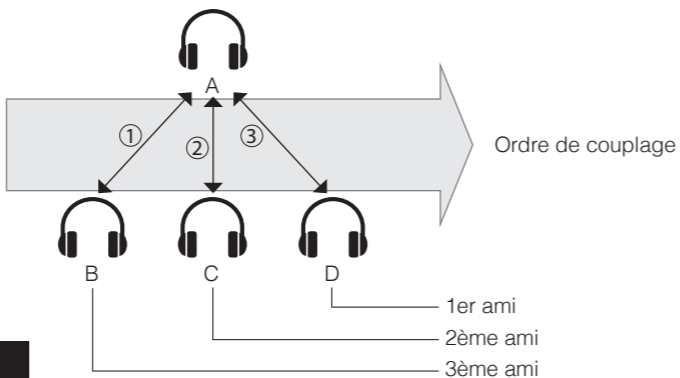

Démarrer Intercom

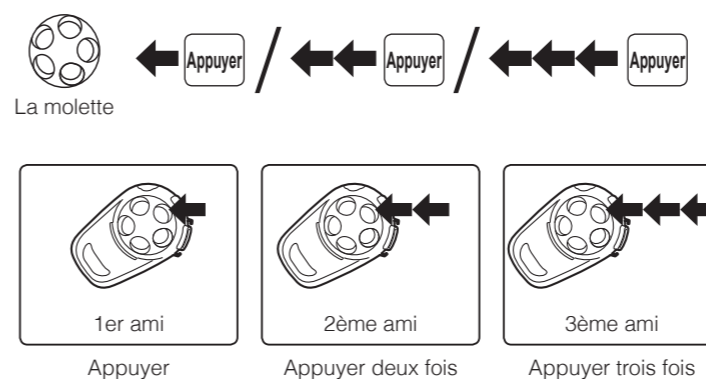

Raccrocher Intercom

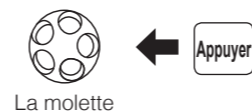

Réinitialisation

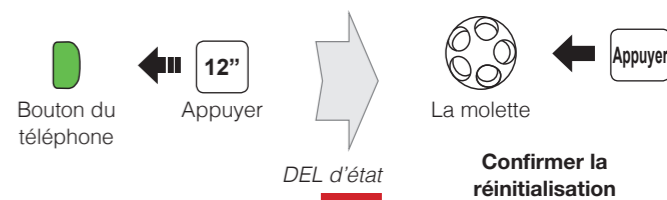

La version complète du manuel peut être téléchargée sur www.sena.com/fr.



Sena Technologies, Inc.
www.sena.com/fr
Assistance client: support.sena.com
Courriel: support.fr@sena.com