

HJC PACKTALK
HJC 4x | HJC SPIRIT

INSTALLATION GUIDE

EN/DE/FR/IT/ES/JP/CN

CONTENTS

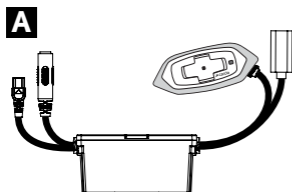

Short cord on Right (R) speaker
Kurzes Kabel am rechten (R) Lautsprecher
Cordon court sur haut-parleur droit (R)
Cavo corto sull'altoparlante destro (R)
Cordón corto en el altavoces derecho (R)
右(R)スピーカーの短いコード
右边(R)扬声器上的短线

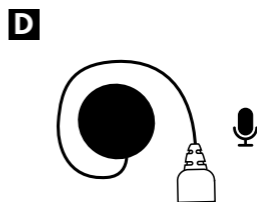
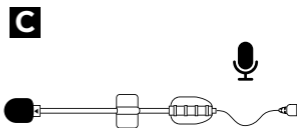

Velcro
Klettverschluss
ベルクロ
魔术贴



Velcro
Klettverschluss
ベルクロ
魔术贴



Booster
Amplificateur
Cuscinetti
Ampificador
ブースター
增强垫

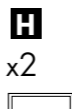

CLEANING
PAD

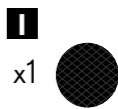

Mic Booster
Amplificateur
Cuscinetti
Ampificador
ブースター
增强垫



1 REMOVE PADDINGS

Polsterung entfernen

Enlever le rembourrage

Rimuovere le imbottiture

Quitar los rellenos acolchados

ディングを取り除く

移除填充物

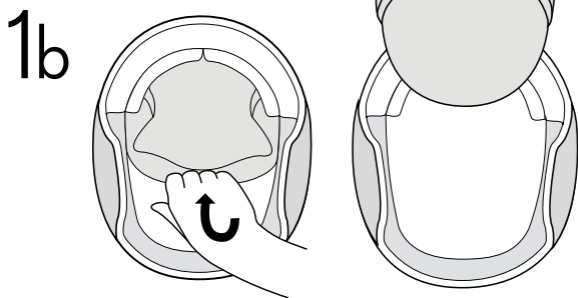
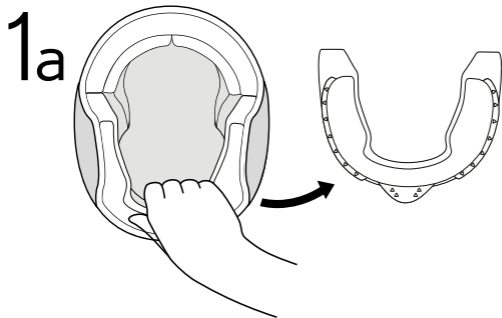

2 REMOVE CAVITY PLACEHOLDER

Cavity location

Hohlraum-Position

Emplacement de la cavité

Posizione della cavità

Ubicación de la cavidad

キャビティ位置

孔洞位置

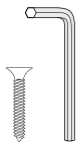
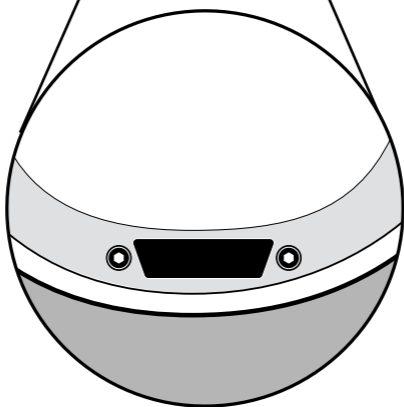
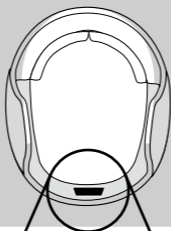

3 PLACE SPEAKERS

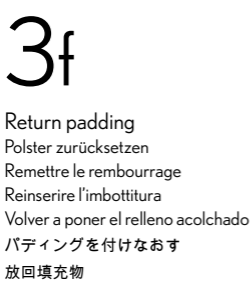
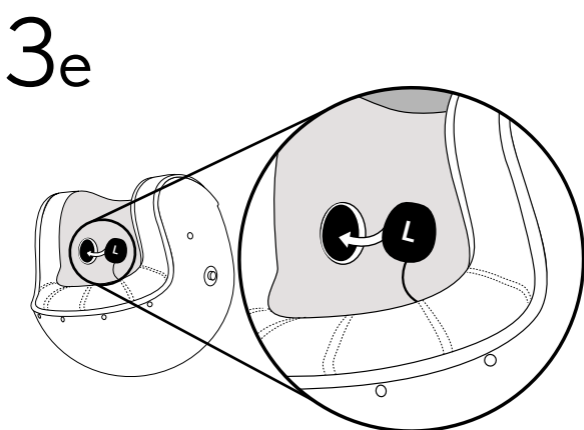
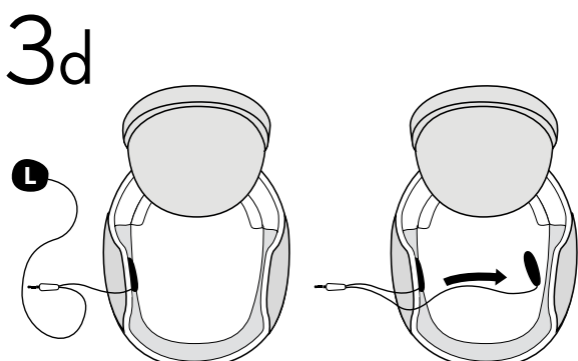
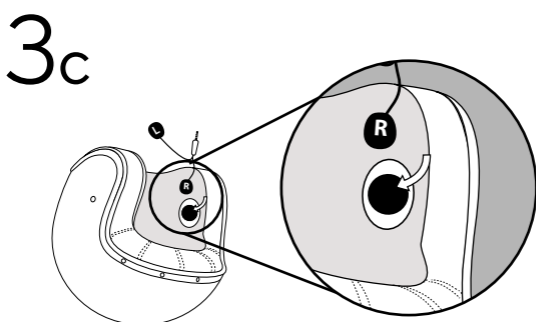
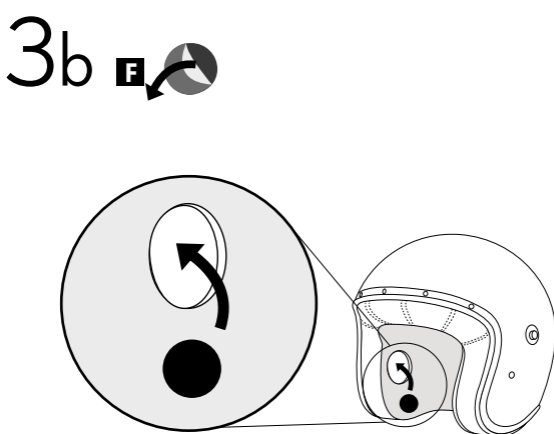
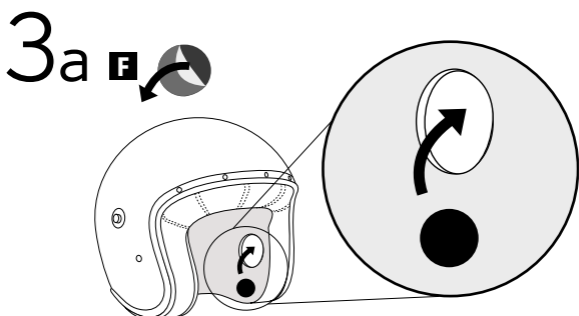
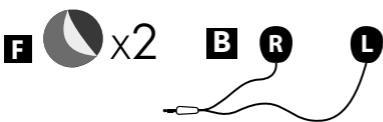

4 INSTALL MICROPHONE

Option 1

Open-face/off-road helmet installation

Installation eines Jet-/Offroad-Helms

Installation d'un casque ouvert ou tout-terrain

Installazione casco jet/fuoristrada

Instalación de cascos descubiertos/todoterreno

オープンフェイス/オフロードヘルメットへの取り付け

安装露脸/越野头盔

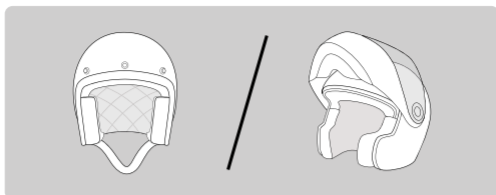

4a **B** x2

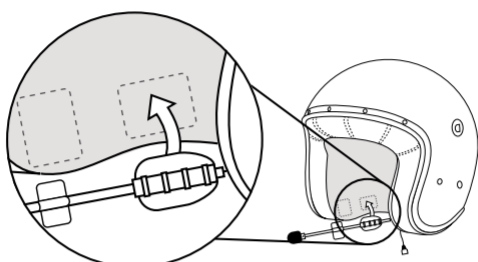

Place the mic to position the velcros

Platzieren Sie das Mikrofon, um die Klettverschlüsse zu positionieren

Placez le micro pour positionner les velcros

Posizionare il microfono per collocare i velcro

Colocar el micrófono para poner los velcros

マジックテープを位置づける為にマイクを付ける

放置麦克风以固定魔术贴

4b **F**

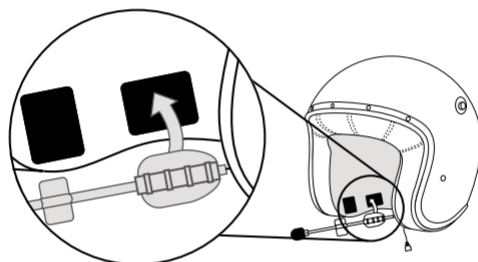

4c

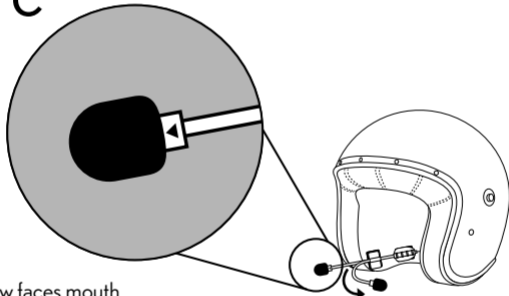

Arrow faces mouth

Pfeil zeigt zum Mund

La flèche doit faire face à la bouche

La freccia è rivolta verso la bocca

La flecha va a la boca

矢印が口に向かうように

箭头面向嘴部

Option 2

Full-face helmet installation

Installation an Integralhelm

Installation sur casque intégral

Installazione su casco integrale

Instalación en el casco de cara completa

フルフェイスヘルメットへの取り付け

全面罩式头盔安装



4a* **I**



4b* **E**

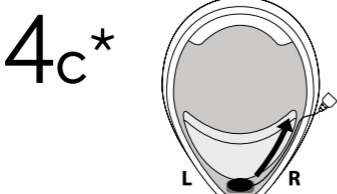

5 INSERT BACK UNIT

5

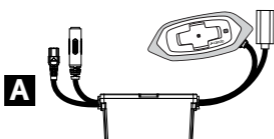

Screw in
einschrauben
visser
avvitare
atornillela
ねじ込む
旋入

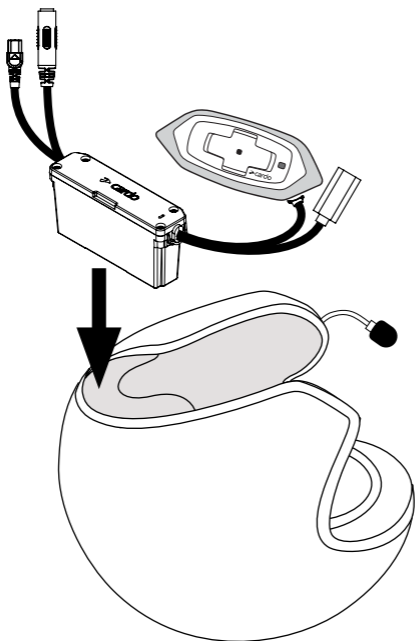

6 CONNECT WIRES

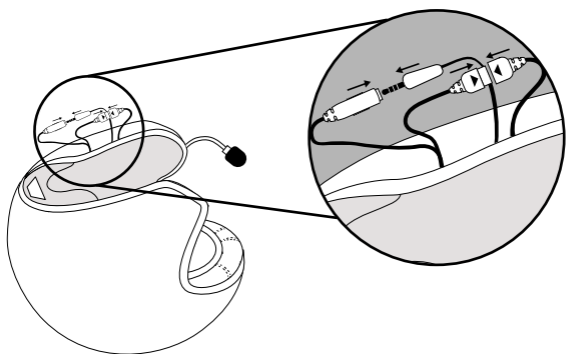

7 PLACE THE SIDE UNIT

7a

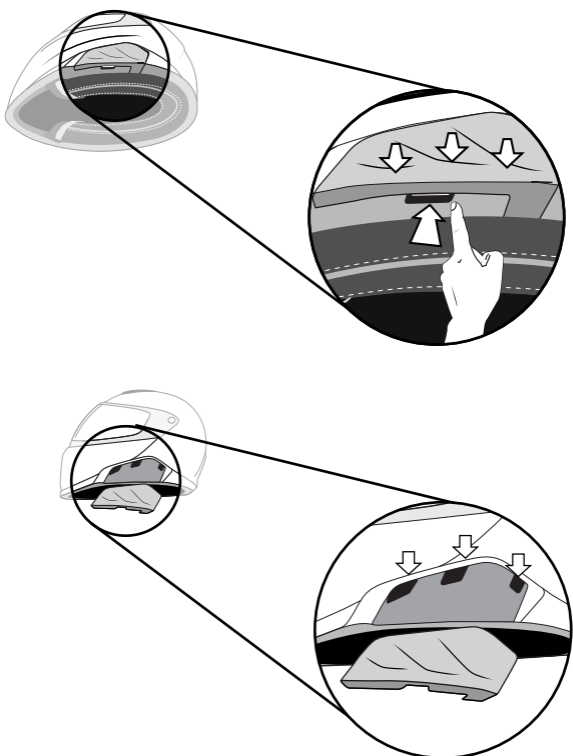

7b

Place cable in designated slot
Kabel in den dafür vorgesehenen Schlitz einlegen
Insérez le câble dans l'emplacement prévu à cet effet.
Inserire il cavo nell'apposito alloggiamento.
Coloque el cable en la ranura designada.
ケーブルを所定のスロットに挿入する
将电缆放入指定插槽

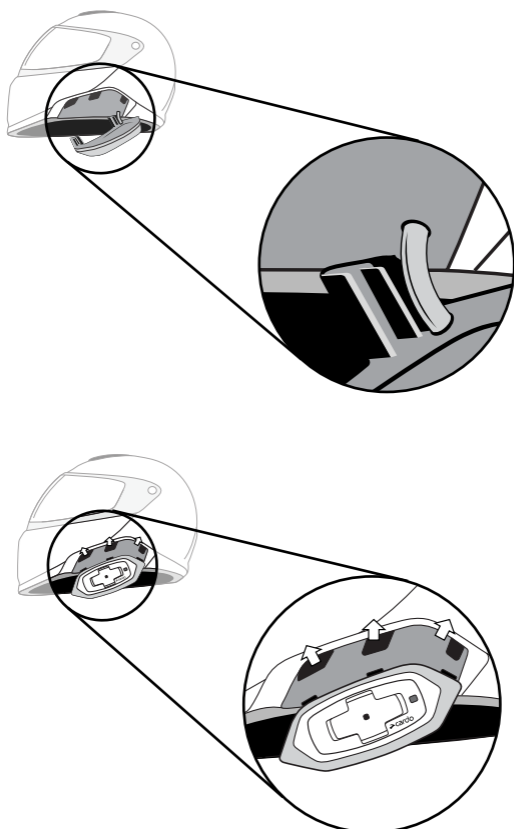

8 PLACE WIRES

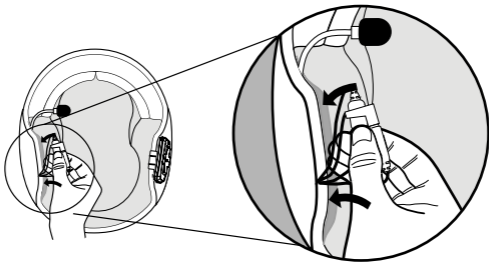

9 RETURN PADDING

Polster zurücksetzen
Remettre le rembourrage
Reinsérer l'imbottitura
Volver a poner el relleno acolchado
パディングを付けなおす
放回填充物

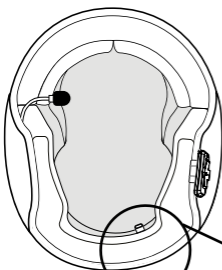
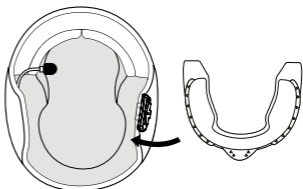

Keep the USB charging port accessible
Sorgen Sie dafür, dass der USB-Ladeanschluss zugänglich ist
Gardez le port USB accessible
Mantenere la porta di ricarica USB accessibile
Mantén accesible el puerto de carga USB
USB充電ポートが利用できる状態にする
保持 USB 充电端口可以访问

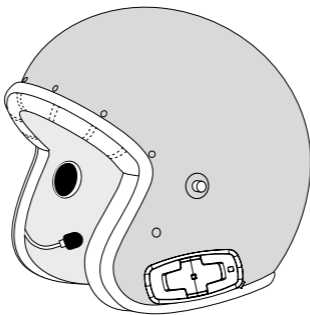
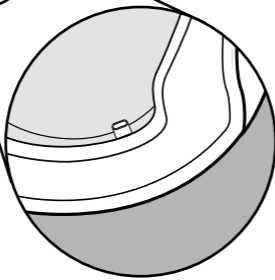

10 BOOSTER PADS

Optional   x2  ↔ 

If needed, use booster pads to place speakers closer to ear
Bei Bedarf Booster-Pads verwenden, um die Lautsprecher näher am Ohr zu platzieren
Si nécessaire, utilisez des coussinets de rattrapage pour rapprocher les haut-parleurs de l'oreille
Se necessario, utilizzare i cuscinetti per posizionare gli altoparlanti più vicino all'orecchio
Si es necesario, use almohadillas de amplificadores para poner los altavoces cerca de la oreja
必要に応じて、ブースターパッドを使ってスピーカーを耳に近づけます
如果需要，请使用增强垫将耳机放置在更靠近耳朵的地方

10a

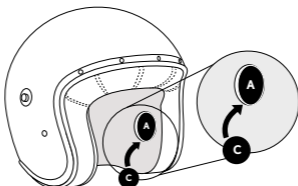

10b

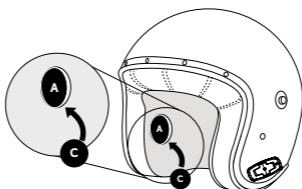



STAY IN
TOUCH



Cardo Support

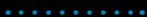

Follow Cardo

